

Gustav Magenwirth GmbH & Co. KG  
Stuttgarter Straße 48  
72574 Bad Urach, Germany  
powersports@magura.de

MAGURA Bike Parts GmbH & Co. KG  
Eckisstraße 6  
72574 Bad Urach, Germany  
info@magura-bikeparts.de

MAGURA USA Corp.  
724 West Clem  
Olney, IL 62450, USA  
magura@magurausa.com

MAGURA Asia Limited Co.  
No. 9, Industrial Park 10th Road  
Shi-Tun District  
Taichung City, 40755, Taiwan  
info@magura.com.tw



© MAGURA, 2,500  
All rights reserved. | Printed in Germany | 2600068, 09.2012  
Layout and design: 4zig, Reutlingen  
Specifications are subject to change without prior notice.



Photos: Stephan Peters | Rider: Basty Wolter

# ENGLISH MAGURA 2013 POWERSPORTS



**MAGURA**

[magura.com](http://magura.com)



**MAGURA**





Photo: Jens Staudt | Rider: Jo Bauer

## CONTENT

<b>MAGURA since 1893</b>	<b>4</b>
<b>Statements</b>	<b>6</b>
<b>MAGURA Performance Parts for BMW</b>	<b>8</b>
Replacement levers	10
R 1200 GS	11
<b>Handlebars</b>	<b>12</b>
X-line series	14
Accessories	15
<b>Off-Road</b>	<b>16</b>
167 HYMEC Off-Road	18
167 HYMEC Off-Road   Spare parts	20
HYMEC replacement clutch slave cylinders	22
167 Hydraulic brake and clutch master cylinder	24
163 HYMEC Off-Road	26
163 HYMEC Off-Road   Spare parts	28
163 cni/Is Hydraulic clutch master cylinder	30
<b>On-Road</b>	<b>32</b>
Street-HYMEC	34
190 ebz Radial master cylinder	36
190 ebz Radial master cylinder   Spare parts	37
195 Radial master cylinder	38
195 Radial master cylinder   Spare parts	39
<b>Spare parts for brake systems</b>	<b>40</b>
750 Radial supermoto brake system   Spare parts	42
770 Radial double-disc brake system   Spare parts	43
<b>Classics</b>	<b>44</b>
73 Sport brake lever	46
74 Sport clutch lever	46
101 Clutch lever	47
103 Brake-/clutch lever with decompression lever	47
108 Brake lever	47
155 Throttle twist grip with mech. brake	48
156 Clutch lever	48
159 Clutch lever	48
160 Clutch lever	49
225 Hydraulic brake and clutch lever	49
234 Throttle twist grip with mech. brake	50
270 Throttle twist grip with mech. brake	50
273 Throttle twist grip with mech. brake	51
286 Throttle twist grip with hydraulic brake	51
287 Hydraulic brake control	52
288 Hydraulic brake control	52
307 Throttle twist grip	52
309 Throttle twist grip	53
314 Duo throttle twist grip	53
317 Electric throttle twist grip	53
682 2-Gear-shift handle grip	54
683 3-Gear-shift handle grip	55
700 Master brake cylinder	55
<b>Accessories</b>	<b>56</b>
<b>Partners</b>	<b>62</b>

Each major product assembly is identified with a model number and specific 7 digit order code. (Example: Model 73 brake lever, order code 0116934). Always use the 7 digit order code for ordering, this will assure receiving the correct item. **E** after the order code indicates the item is out of production, available only as long as supply lasts.

Pricing delivery and other terms and conditions are those in effect at time of delivery.

MAGURA is a pioneer when it comes to motorcycle componentry. Back in 1923 the very first BMW R23 was fitted with MAGURA parts. 90 years of know-how have been constantly built on since then and have been integrated with 100 years of experience in material selection and hydraulic know how. The aim has always been and continues to be using that know how to realise a current and efficient product range offering parts that will improve the riders control of any motorcycle.

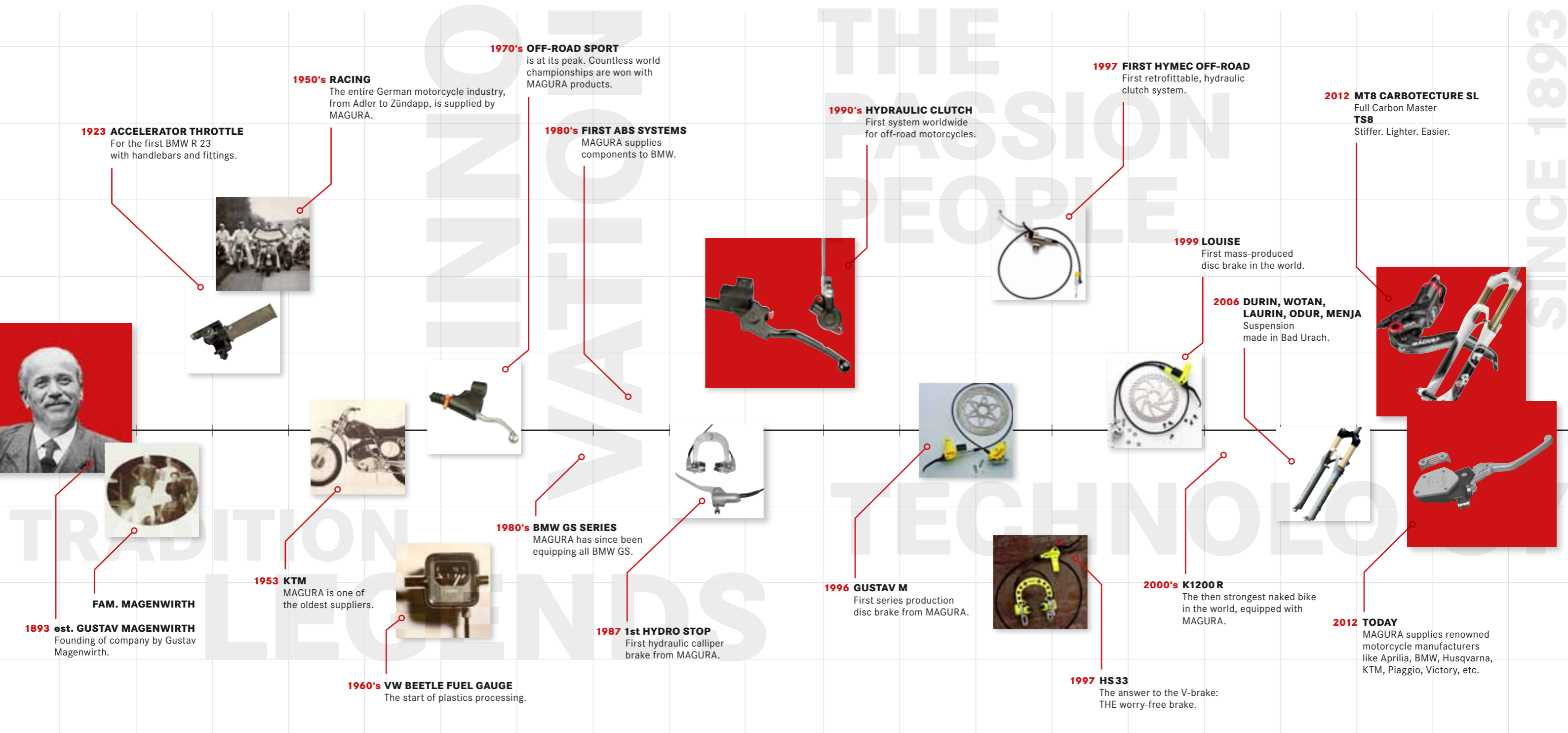

**1923 ACCELERATOR THROTTLE**  
For the first BMW R 23 with handlebars and fittings.



**1950's RACING**  
The entire German motorcycle industry, from Adler to Zündapp, is supplied by MAGURA.

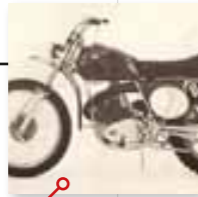

**1970's OFF-ROAD SPORT**  
is at its peak. Countless world championships are won with MAGURA products.

**1980's FIRST ABS SYSTEMS**  
MAGURA supplies components to BMW.



**1990's HYDRAULIC CLUTCH**  
First system worldwide for off-road motorcycles.



**1997 FIRST HYMEC OFF-ROAD**  
First retrofittable, hydraulic clutch system.

**1999 LOUISE**  
First mass-produced disc brake in the world.



**2006 DURIN, WOTAN, LAURIN, ODUR, MENJA**  
Suspension made in Bad Urach.



**2012 MT8 CARBOTECTURE SL**  
Full Carbon Master TSB  
Stiffer. Lighter. Easier.



**1893 est. GUSTAV MAGENWIRTH**  
Founding of company by Gustav Magenwirth.



**FAM. MAGENWIRTH**

**1953 KTM**  
MAGURA is one of the oldest suppliers.



**1960's VW BEETLE FUEL GAUGE**  
The start of plastics processing.

**1980's BMW GS SERIES**  
MAGURA has since been equipping all BMW GS.



**1987 1st HYDRO STOP**  
First hydraulic calliper brake from MAGURA.

**1996 GUSTAV M**  
First series production disc brake from MAGURA.

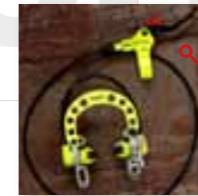
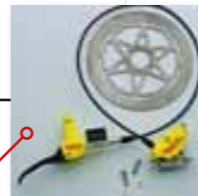

**1997 HS33**  
The answer to the V-brake: THE worry-free brake.

**2000's K1200 R**  
The then strongest naked bike in the world, equipped with MAGURA.

**2012 TODAY**  
MAGURA supplies renowned motorcycle manufacturers like Aprilia, BMW, Husqvarna, KTM, Piaggio, Victory, etc.

SINCE 1893

THE PASSION PEOPLE

TECHNOLOGY

TRADITION LEGENDS



**DIRNDLER RACING**

"We are impressed by the performance of the carbon brake pads from MAGURA (for the 750 Supermoto calliper). After a brief warm-up phase, these brake pads always provide exceptional braking effectiveness! This has advantages, especially with hard braking manoeuvres. Noticeably later braking points are the result!"

**MR. HAYABUSA ELMAR GEULEN**

"A clear statement - for me there are really no better brake & clutch pumps than your MAGURA products."



**MARKUS VOLZ**  
(Runner-up in German Supermoto 2011)

"The extremely impressive braking performance of my MAGURA brake enabled me to brake ,late' and win the second-place title without any technical problems! MAGURA's materials and quality as well as their cooperative spirit are top-tier. MAGURA products belong on the bikes of hobbyists and fully professional riders alike."



**CHRIS PFEIFFER**

"About the CPX handlebar I can only say that it has the optimal shape for stunting and trials. But I also have the CPX on my enduro. I've always sworn by a rather "straight" handlebar with little backwards bend. The CPX gives a decisive advantage to all stunt riders: it has 230 mm of space for a rubber grip, clutch and handbrake. Other handlebars usually have barely 200 mm and that makes it difficult to accommodate two fittings well. And it's also very strong. It's my absolute first choice for my enduro and trials bikes and of course for my stunt bike.

The 195 radial clutch fitting is the optimal handbrake for a stunt bike. Yes, that's right, I use it as a handbrake and not as a clutch. In the 13 mm version it has the optimal transmission and lever mechanics for a snappy handbrake - just what we stunt riders are looking for."

**LUKAS HÖLLBACHER** Cofain Supermoto Racing Team  
(Austrian 2nd place, German champion 2011)

"The performance is on the mark at all times, whether when training or under tough racing conditions. As a rookie, who still falls a lot, I would also like to say that the MAGURA RADIAL 190 is nearly indestructible."

**HANNES MAIER** Cofain Supermoto Racing Team  
(Austrian double champion 2011)

"The MAGURA RADIAL 190 stands out with its constantly hard pressure point and lends an enormous feeling of security, especially on slippery and loose ground! The ergonomically shaped brake lever and the design and workmanship speak for themselves! When performance is important, in my opinion, there is no way around the MAGURA RADIAL 190!"



**STEFAN EKEROLD**

"I've been riding with MAGURA products for around 6 years and I am especially impressed by your handlebars. They are very robust, don't bend as quickly after falls as other handlebars do and there is a large selection of handlebar shapes, which means that anyone can find the right shape for them."

**JON EKEROLD** Team manager of the Bodo Schmidt KTM Junior Team

"As the person responsible for the technical side of the Bodo Schmidt KTM Junior Team, I insist on using the best products for our motocross motorcycles. This is why we have been relying on the quality and strength of MAGURA MX products for the past 6 years."

**ROK BAGOROS**

**MAGURA X-line "CPX":** "Every day I take several falls during my stunt training and there is still no trace of bending or cracks. The handlebar is practically indestructible! It has the perfect shape for all stunt tricks and enough room for all of the stunt levers we have integrated!"

**MAGURA brake calliper:** "Stunt riders need very strong brakes to keep wheelies and circles under control. The brake needs to keep holding after long dragging, and it does. A TOP product."

**MAGURA radial pump 195:** "With stunts it is very important to have a brake pump that provides a good pressure point because you need that responsiveness when performing stunts. With this pump, you can not only brake strong or just a little, you can really play with the braking power. This pump is a **MUST** for stunt riders!"

**DAVIDE ZITZEWITZ** BVZ Racing Team

"I have been riding with the MAGURA SX handlebar for years because it has a great shape and is extremely strong. It really suits my riding style well."

**DIRK THELEN**

"When racing, training and teaching, the quality of the products I use when I ride is especially important. That's why I have been trusting products from MAGURA for years. You only have two real contact points with the motorcycle: The handlebars and the footrests. You have to be able to rely on them. That's why I'm so grateful for the consistently high quality of MAGURA products."





# MAGURA PERFORMANCE PARTS FOR BMW

MAGURA HAVE BEEN SUPPLYING PARTS TO BMW  
MOTORCYCLES ON EVERY MODEL SINCE 1923.

WHEN IT COMES TO CONTROL NOBODY DOES IT  
BETTER. THE EXPERIENCE OF OVER 90 YEARS  
FLOWS INTO OUR AFTERMARKET PRODUCTS TO  
ENSURE THAT AN UPGRADE IS JUST THAT.







HYMEC for F800 – available to order from spring 2013!



WITH ABE

**MAGURA PERFORMANCE PARTS FOR BMW**

MAGURA replacement levers represent an improvement on motorcycles since 1923. The ergonomics, material quality and finish are first class. Tested and approved by the TÜV organisation in Germany these levers meet and surpass the highest standards set for master cylinder operation on a motorcycle. Trust MAGURA to offer the best levers for your bike.

MODEL	YEAR	MODEL CODE	CLUTCH LEVER	BRAKE LEVER
<b>650</b> F 650 GS	2007-	K72	Not available	2100016
<b>800</b> F 800 GS F 800 R F 800 S/ST	2007- 2007- 2007-	K72 K73 K71	Not available Not available Not available	2100016 2100016 2100016
<b>1200</b> R 1200 GS/Adv R 1200 R R 1200 S R 1200 ST HP2 Enduro HP2 Megamoto HP2 Sport* K 1200 S K 1200 R K 1200 R Sport K 1200 GT	2003- 2006- 2005- 2004- 2005- 2007- 2007- 2004- 2005- 2005- 2005-	K25 K27 K29 K28 K25HP K25/03 K29HP K40 K43 K43 K44	2100017 2100017 2100017 2100017 2100017 2100017 0722112 2100017 2100017 2100017 2100017	2100016 2100016 2100016 2100016 2100016 2100016 2100016 2100016 2100016 2100016 2100016
<b>1300</b> K 1300 S K 1300 R K 1300 GT	2009- 2009- 2009-	K40 K43 K44	2100017 2100017 2100017	2100016 2100016 2100016

\*This lever is not pictured on this page – please see 195 Radial Master Cylinder (on-road section of this catalogue)



WITH ABE

**R 1200 GS – UPGRADE YOU GS WITH MAGURA PERFORMANCE PARTS**

The new R 1200 GS is set to establish the new benchmark in the Adventure Touring category. How do you improve the best motorcycle controls available? Easy with MAGURA Performance Parts! To celebrate 90 years in the search for perfect control on a motorcycle we have prepared an upgrade kit for your new BMW Motorcycle comprising three separate elements.

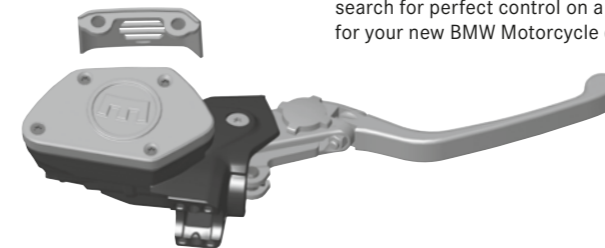

MAGURA Performance Parts will add value to your motorcycle. They are designed to stand the test of time and can be ordered and fitted separately or together as you wish. The materials used are lightweight and extremely durable and strong – we would like to wish you many miles of motoring pleasure with your upgrade – each product contains 90 years of motorcycling Know How combined with our passion for perfection.

**Reach Adjust Selector Kit |** Honed from top grade aluminium this replacement for the standard reach adjuster is plug and play. Can be fitted with the standard lever or with the MAGURA upgrade fold away lever kit.

**Fold Away Lever Kit |** Honed from top grade aluminium with position detent lock and fully ABE tested and approved. Can be fitted with the standard reach adjuster or with the MAGURA upgrade reach adjust selector kit. Fold Away Lever Kit pictured features upgrade Reach Adjust Selector Kit, must be ordered separately.

**CNC Reservoir Cover Kit |** Honed from top grade aluminium this kit will add optically to your new BMW. Reservoir breather remains fully functional and an optional fluid level sight glass protector is included just in case you intend to use the bike to cross continents.

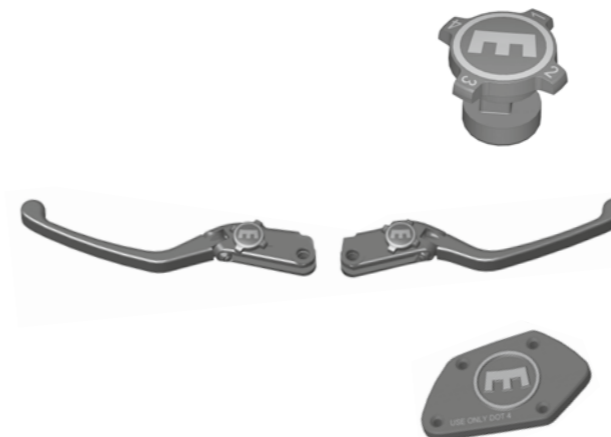



REDUCED RIDER FATIGUE

ERGONOMICALLY DESIGNED

LIGHT

ROBUST

# HANDLEBARS





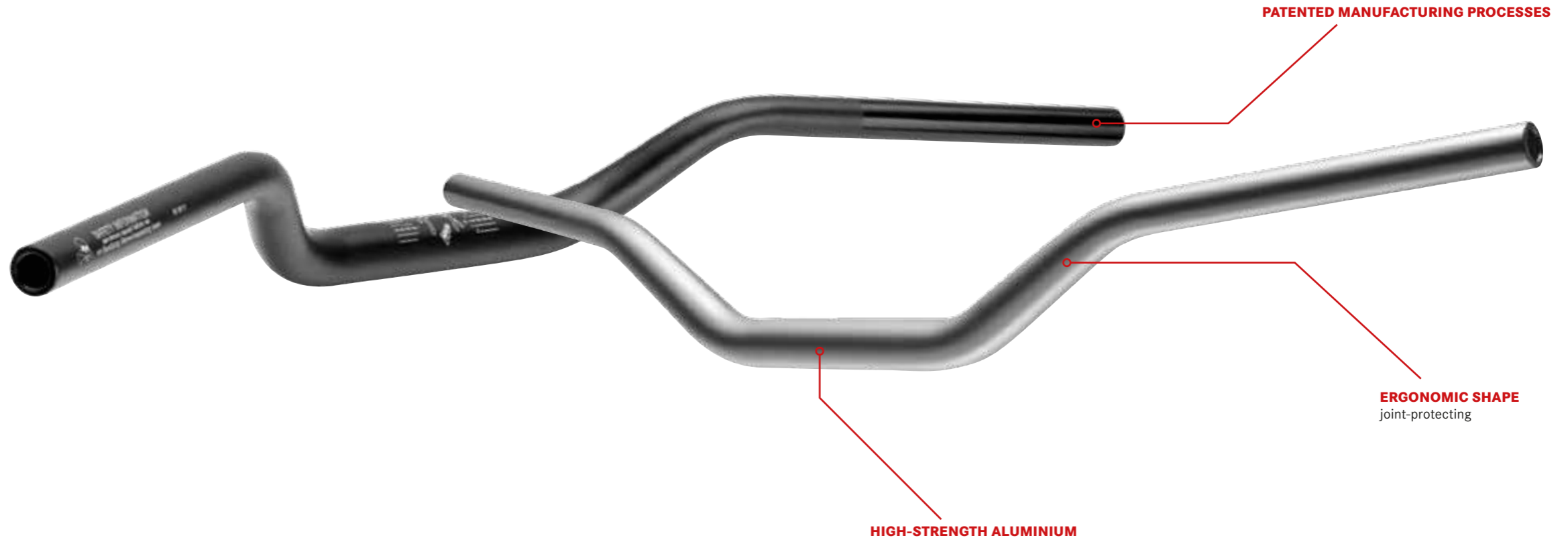

**X-LINE SERIES**

The bulged alloy handlebars from MAGURA: Light, stable, reduced rider fatigue! Ball burnished finish for increased lifetime durability. MAGURA-quality handlebars are TÜV approved. Patented: DE 197 07 203/US 5,950,497

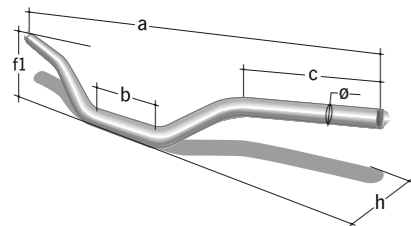

ORDER CODE	MODEL	COLOR	DIMENSIONS in mm				
			a	b	c	f1	h
0723198	Big-Enduro Handlebar	Silver	827	134	230	206	100
0721245	MX2 Motocross, Supermoto	Silver	808	135	189	119	77
0722019	QX1 Quad	Silver	808	135	189	119	77
0722020	QX2 Quad	Silver	795	135	186	120	87
0723050	CX "Street"	Silver	805	135	200	117	76
0721053	EX Enduro	Silver	795	135	186	120	87
0721054	JX Junior-Motocross	Silver	768	135	169	117	60
0721052	MX Extreme Motocross	Silver	808	135	195	105	80
0721055	SX Supercross, Supermoto, Motocross	Silver	808	135	189	120	63
0723248	TX Touring	Black	797	139	217	138	97
0723247	FX Streetfighter	Black	750	137	210	98	107
0723221	SX "Street"	Black	808	135	189	120	63
0723283	CPX - Chris Pfeiffer Edition	Black	805	131	231	117	76

**ACCESSORIES**

<p>X-line fork clamp kit for bikes with split clamp. Screw M 10x70, with bushings.</p> <p><b>OFF-ROAD</b> Order code 0720474</p>	<p>X-line clamp kit for one piece clamp/ fork bridges. Fits HONDA, YAMAHA, SUZUKI etc., hole distance 32-36 mm.</p> <p><b>OFF-ROAD</b> Order code 0720488</p>	<p>MAGURA-Barpad, color: black.</p> <p>Order code 0723058</p>	<p>New black X-line "Street" clamp kit for bikes with split clamp (complete).</p> <p><b>ON-ROAD</b> Order code 0723270</p>	<p>New black X-line "Street" clamp kit for 22 mm clamp conversion, clamping range 32-36 mm.</p> <p><b>ON-ROAD</b> Order code 0723271</p>	<p>New black X-line "Street" clamp kit for 22 mm clamp conversion, allows 16 mm movement of handlebar forwards and backwards as required from the top of the triple clamp.</p> <p><b>ON-ROAD</b> Order code 0723272</p>
--	---	---	--	--	---



# OFF-ROAD

LESS MAINTENANCE

ROBUST

EASY TO MOUNT

EXCELLENT MODULATION





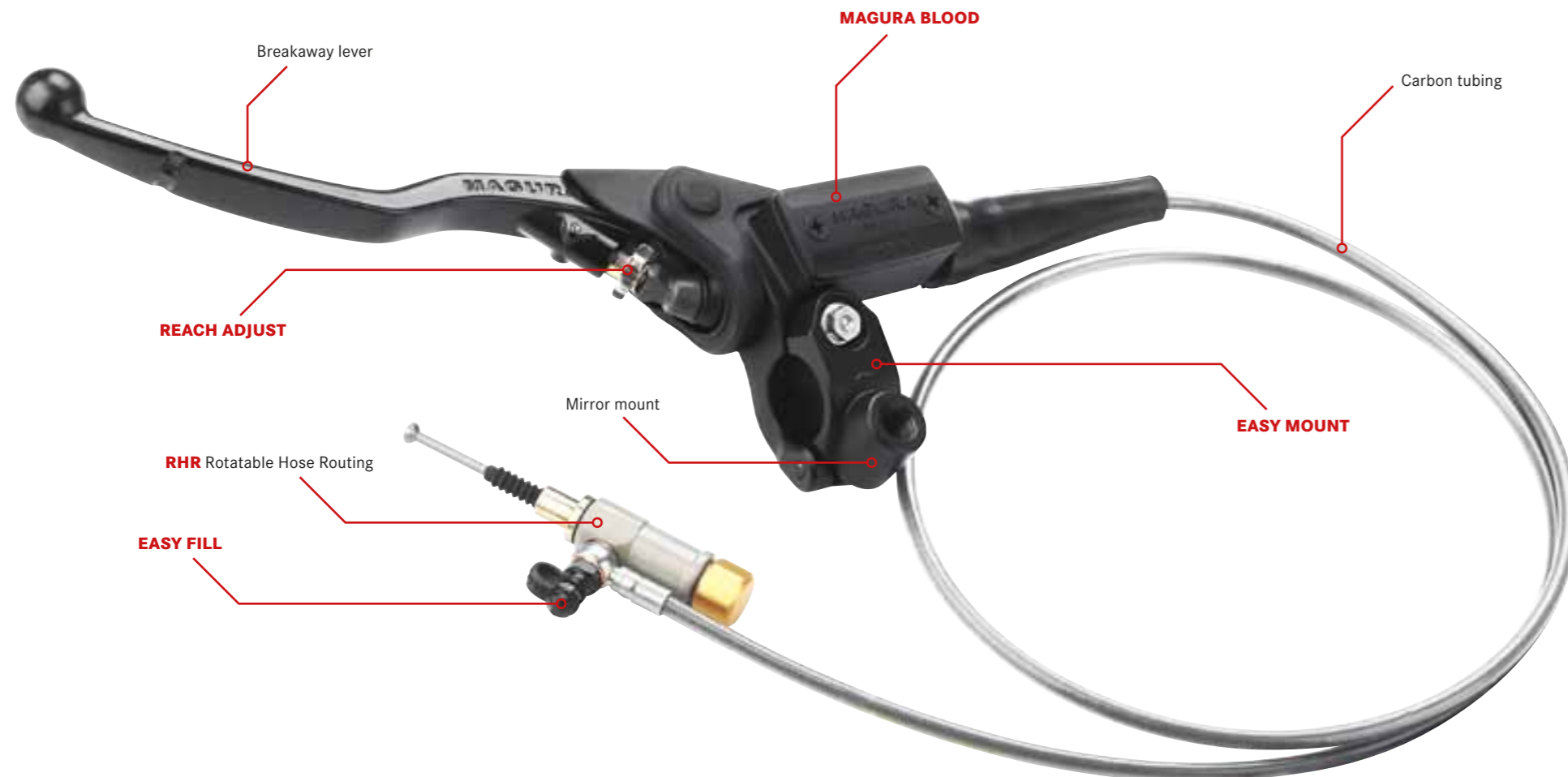

**NEW!**

**167 HYMEC | HYDRAULIC CLUTCH SYSTEM**

- > Master cylinder | 167 cni | black
- > Master piston Ø | 9.5 mm
- > Excellent modulation
- > Reduced operating force required up to 20%



**167 HYMEC | OFF-ROAD**

MAGURA HYMEC – An easy to install alternative to a mechanical clutch. This system replaces the clutch lever and cable – with a small lightweight hydraulic system for improved clutch control. The HYMEC ensures an easier operating pressure, a constant pressure point, no more cable adjustment and smooth clutch actuation to ensure the perfect take-off every time.

Clutch operation with the MAGURA hydraulic kick. The thousand-fold proven hydraulic clutch operating system for Motocross and Enduro. Superior technology which unites an abundance of unique advantages into one: No fading, superfine modulation, almost maintenance-free, automatic compensation for clutch wear and up to 20% less actuating force! HYMEC provides a uniquely sensitive operation and significantly improves vehicle control. A weight saving of up to 150 grams is possible according to the model.

MODEL	YEAR	ORDER CODE CNI	FOLLOW-UP MODEL black	MASTER CYLINDER	HOSE LENGTH in mm	PISTON Ø in mm	ASSEMBLY SIZE	REPLACE SLAVE
<b>HONDA</b>								
CRF 150	2008–2010	0120681 <b>B</b>	2100004	167 cni	1,045	9.5	70	2100003
CRF 250 R	2006–2009	0120688 <b>B</b>	2100009	167 cni	1,045	9.5	57	0120655
CRF 250 R	2010	0120683 <b>B</b>	2100005	167 cni	1,045	9.5	57	0120655
CRF 450 R	2004–2008	0120682 <b>B</b>	2100007	167 cni	1,045	9.5	41	0120649
CRF 450 R	2009–2010	0120683 <b>B</b>	2100005	167 cni	1,045	9.5	57	0120655
<b>KAWASAKI</b>								
KX 250 F	2009	0120684 <b>B</b>	2100006	167 cni	1,120	9.5	65	0120651
KX 450 F	2009	0120685 <b>B</b>	2100007	167 cni	1,045	9.5	98 <sup>1)</sup>	0120649
<b>SUZUKI</b>								
RM-Z 250	2009	0120741 <b>B</b>	2100011	167 cni	1,045	9.5	81 <sup>1)</sup>	0120649
RM-Z 450	2009	0120742 <b>B</b>	2100012	167 cni	1,045	9.5	81 <sup>1)</sup>	0120649
<b>YAMAHA</b>								
YZ 250 F	2009	0120687 <b>B</b>	2100008	167 cni	1,120	9.5	59	0120652
YZ 450 F	2009	0120687 <b>B</b>	2100008	167 cni	1,120	9.5	59	0120652

Maximum stroke | 10.5–11.5 mm  
 Lever ratio | 1:4  
 Slave cylinder piston | Ø 10.5 mm  
<sup>1)</sup> Slave Cylinder attached at rear (0430998)

FROM CNI TO BLACK



167 HYMEC | MASTER CYLINDER

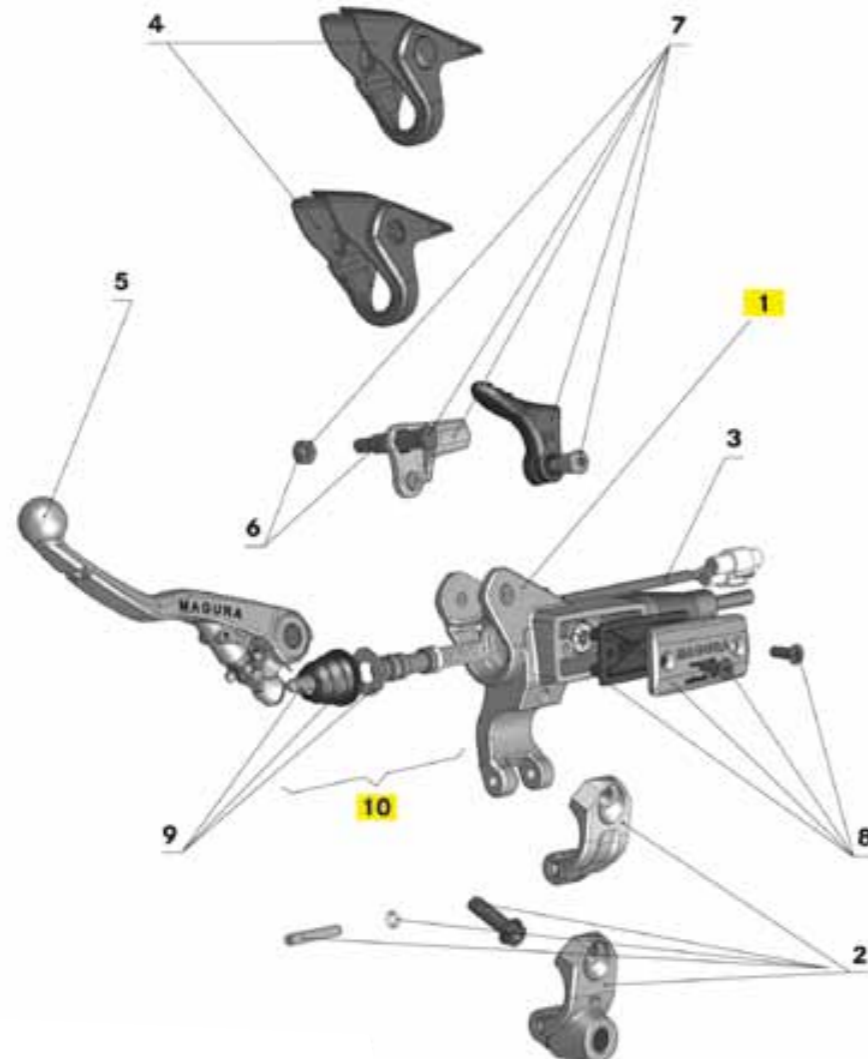

167 HYMEC | SLAVE CYLINDER

⚠ Slave cylinder seal-kits not available as spare parts!

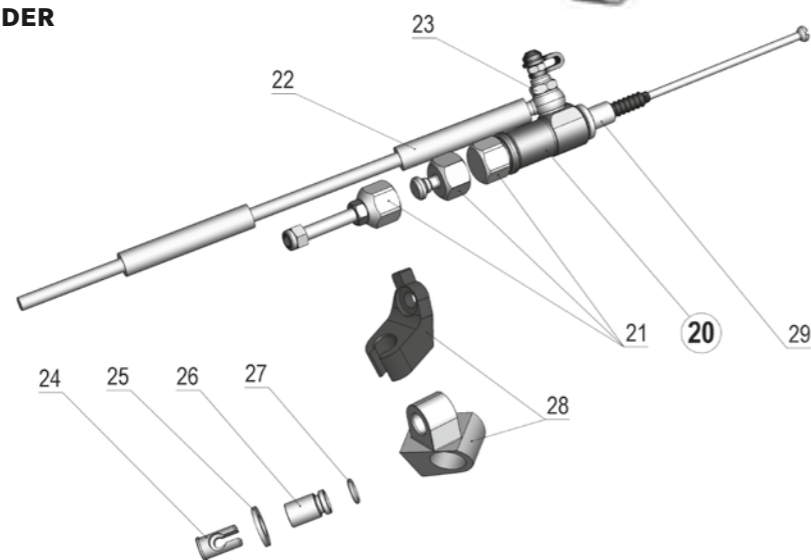

167 HYMEC | SPARE PARTS

POSITION	DESCRIPTION	ITEM CODE	FOLLOW-UP MODEL
1	Master cylinder*	Page 24/25	
2	Clamp with spiral spin Clamp for threaded mirror mounting M 10x1.25 mm	0723118 B 0723183 B	2700176 2700177
3	Clutch switch	0723187	
4	Protection cover for lever without choke lever Protection cover for lever with choke lever	0723163 0723202 B	
5	Long lever blade with adjustment wheel l = 146 mm Short lever blade with adjustment wheel l = 123 mm Black lever blade with adjustment wheel l = 163 mm	0723290 0723121 0723296	
6	Screw for lever	0723115	
7	Deco lever black Hot start lever red	0723189 0723188	
8	Reservoir cover for mineral oil use with bellow and screws Reservoir membrane	0723164 B 0723162	2700178
9	Bellows with push rod and washer	0723116	
10	Master piston Ø	9,5 mm 10,5 mm	0723184 0723185
20	Slave cylinder	Page 22/23	
21	Cap bronze anodised Cap with stud bronze anodised Cap "universal"	0430217 0430998 2100018	
22	Tubekit PA with accessories l = 1,045 mm Tubekit PA with accessories l = 1,120 mm Tubekit carbon with accessories l = 1,120 mm Tubekit CARBON with accessories l = 1,045 mm Tubekit PA with accessories l = 1,500 mm	0720549 0720550 0722137 0722138 0722679	
23	Banjo bolt with bleeding valve for carbon tubings M 6x16.5 mm	0722136	
24	Sleeve	0412310	
25	Disc	0451530	
26	Sleeve for HYMEC 0120594 Sleeve for HYMEC 0120585	0430985 0430987	
27	O-ring (needed for sleeve 0430985 and 0430987)	0488255	
28	Mounting adapter Honda CRF 450 R, model year 2004 Mounting adapter Suzuki RM-Z 250, Kawasaki KXF 250 Mounting adapter Kawasaki KX 450 F, model year 2006	0430220 0430240 0430997	
29	Support	0430224	
30	MAGURA-Blood 100 ml MAGURA-Blood 1 liter	0721820 0721821	

\* If the master cylinder with decompression lever or choke lever is needed, you have to order additionally Pos. 7 and 8.







### REPLACEMENT HYMEC CLUTCH SLAVE CYLINDERS

If you have an older HYMEC clutch activation system and require a replacement slave cylinder but are not aware of the correct part number we have devised a method to make it easier for you to establish the part number for the replacement.

Remove the slave cylinder from the motorcycle and activate the master cylinder until the slave cylinder activation rod is fully retracted and withdrawn. The piston in the slave cylinder is now contacting the bronze cap at the back of the slave cylinder and the rod length should be measured as shown in the table below. If the slave cylinder is no longer working it can be removed from the pressure line and forced slowly and carefully into the slave cylinder for the measurement.

Please note – the length you are measuring is not the activation length – the activation length is 16mm longer than the withdrawn length. Following the measurement please do not disregard your old slave cylinder you may require the cap or the support. All of our replacement HYMEC slave cylinders are delivered with the standard cap and standard support as shown in the pictures. If the slave cylinder you require lies between two different activation lengths – always order the longer version and use spacers between the support and the cable attachment to increase the activation length to suit your motorcycle.

ORDER CODE	WITHDRAWN LENGTH in mm	ACTIVATION LENGTH in mm
0120649	24	39 to 41
0120648	31	46 to 48
0120655	35	51 to 53
0120652	41	56 to 58
0120651	45	60 to 62
2000081	50	65 to 67
0120653	55	70 to 72
0120659	67	82 to 84
0120657	90	105 to 107

### OPTIONAL EXTRAS FOR YOUR SLAVE CYLINDER



Nipple: If your clutch cable has a large attachment nipple you will require a nipple for the end of your HYMEC slave cylinder activation rod.

**Order code 0412310**



Universal Attachment Kit: This kit facilitates the attachment of the HYMEC slave cylinder from the rear cap. It has an adjustable range and will add 55 to 70 mm to the activation length when used in conjunction with any of the slave cylinders listed above.

Please note that the slave cylinder rear cap has a secondary breather function and should not be sealed when replaced.

**Order code 2100018**



Cap with Stud: If your HYMEC is attached from the rear you may require the cap with stud. This part is designed only for use with model specific adaptors – see page 21 position 21.

Please note that the slave cylinder rear cap has a secondary breather function and should not be sealed when replaced.

**Order code 0430998**



Sleeve for 2 Stroke Models – If the HYMEC slave cylinder is located under the clutch cover it may be necessary to use one of the sleeves in conjunction with an o-ring – see page 21 position 26/27.

Sleeve for 2-stroke models:

**Order Code**

**0430985** 15 mm long version

**0430987** 12 mm short version

**0488255** O-ring fits both of the above versions

Replacement HYMEC Slave Cylinders – to measure your slave cylinder – activate the master cylinder until the pull rod is fully withdrawn.

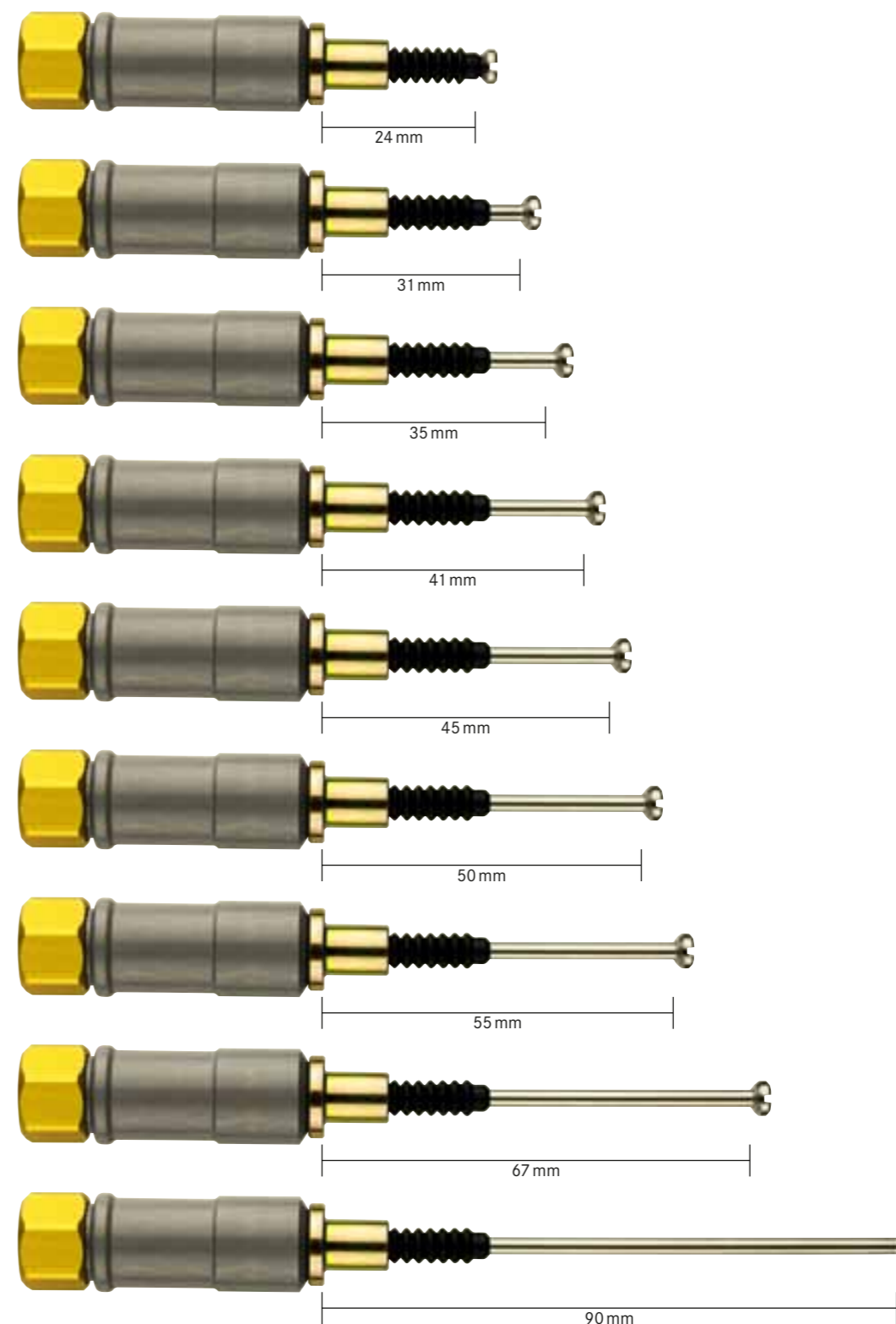

### ACTIVATION LENGTH

39–41 mm  
**Order code 0120649**

46–48 mm  
**Order code 0120648**

51–53 mm  
**Order code 0120655**

56–59 mm  
**Order code 0120652**

60–62 mm  
**Order code 0120651**

65–67 mm  
**Order code 2100003**

70–72 mm  
**Order code 0120653**

80–84 mm  
**Order code 0120659**

105–107 mm  
**Order code 0120657**



### 167 HYDRAULIC BRAKE AND CLUTCH MASTER CYLINDER

Hydraulic brake and clutch control, one piece aluminium cylinder with reservoir, forged and break-proofed alloy lever blade, optimized reach adjustable, easy to fix with a new designed clamp, the compact construction avoids collisions when riding extreme, cylinder and lever blade pivot protected against foreign elements with rubber cap. Available for use with mineral oil or brake fluid.

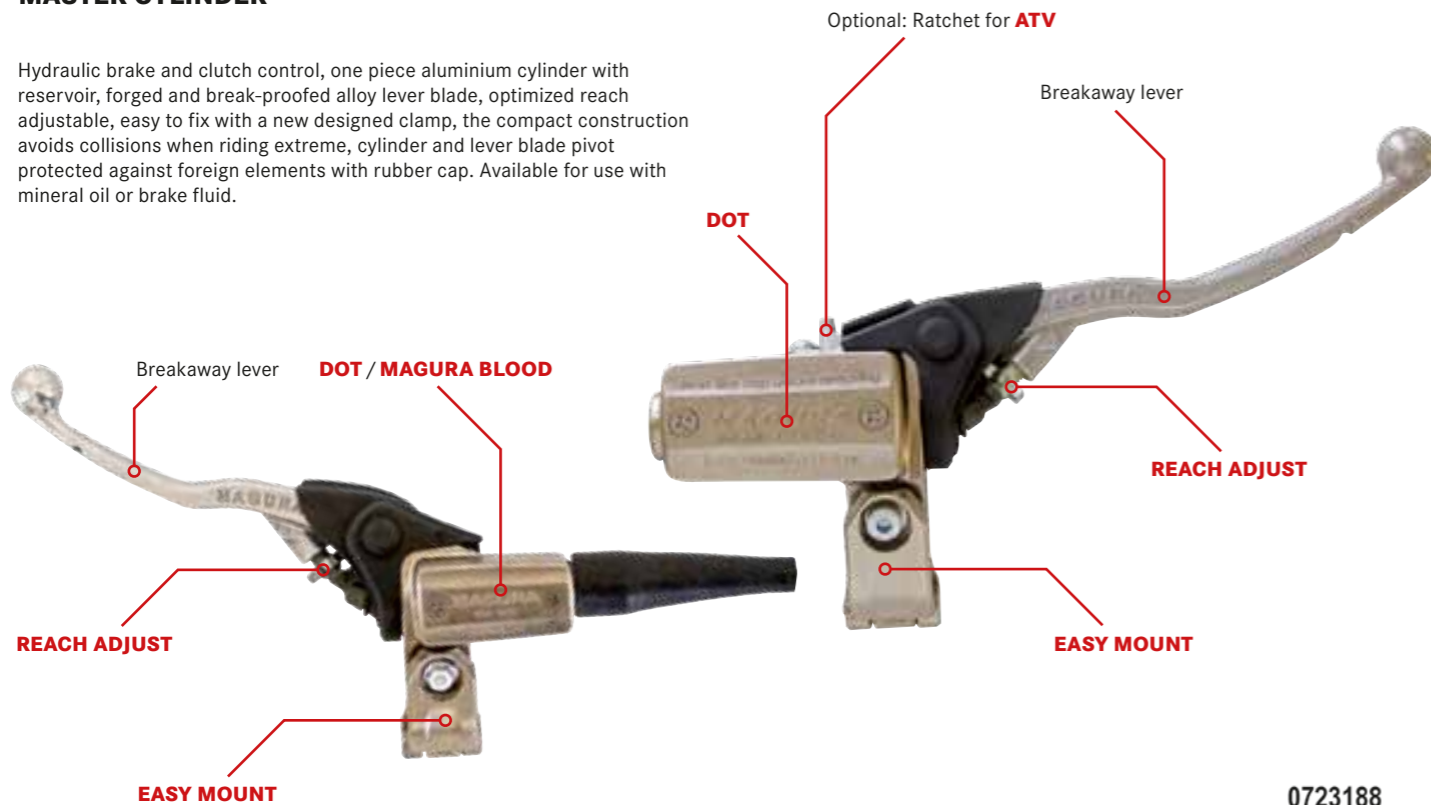

### 167 CLUTCH MASTER CYLINDER

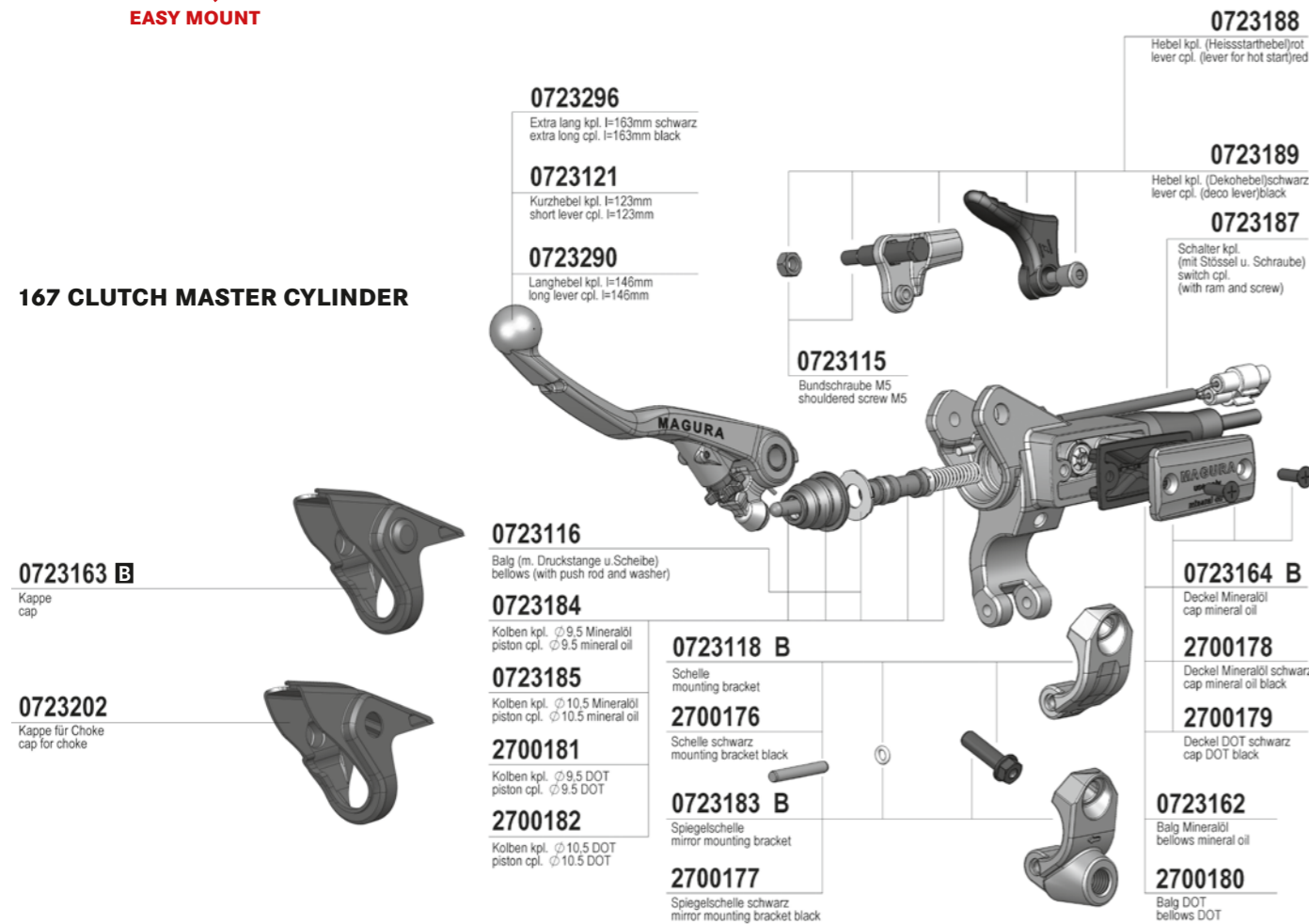

ORDER CODE	MODEL	PISTON Ø in mm	MEDIUM	DESCRIPTION	APPLICATION
<b>CLUTCH</b>					
0723160 B	Master cylinder 167.2 cni	9.5	Mineral oil	Without decompression lever blade	KTM 450 SXF
0723190 B	Master cylinder 167.1 cni/tp	10.5	Mineral oil	With decompression lever blade	
0723193 B	Master cylinder 167.2 cni/tp	9.5	Mineral oil	With lever for reverse gear and clutch switch*	KTM ATV
0723029 B	Master cylinder 167.2 cni	9.5	DOT4/5.1	Without deco, long lever blade	KTM ATV
0723295	Master cylinder 167.2 ls	9.5	Mineral oil	Painted black, black lever, without deco	
0723192	Master cylinder 167.1 cni/tp	10.5	Mineral oil	With hot start lever blade and clutch switch*	
2700183	Master cylinder 167.2 ls	9.5	Mineral oil	Offroad-Master cylinder, silver lever blade 146 mm, deco lever, switch, mirror-mounting bracket	
2700186	Master cylinder 167.1 ls	10.5	Mineral oil	Black Offroad-Master cyl., silver lever blade 146 mm, deco lever, switch, mirror-mounting bracket	
2700184	Master cylinder 167.2 ls	9.5	DOT	Black Offroad-Master cyl., silver lever blade 146 mm, deco lever, switch, mirror-mounting bracket	
2700187	Master cylinder 167.1 ls	10.5	DOT	Black Offroad-Master cyl., silver lever blade 146 mm, deco lever, switch, mirror-mounting bracket	
0723295	Master cylinder 167.2 ls	9.5	Mineral oil	Black Street-Master cyl., black lever blade 163 mm, deco lever, switch, mirror-mounting bracket	
2700185	Master cylinder 167.1 ls	10.5	Mineral oil	Black Street-Master cyl., black lever blade 163 mm, deco lever, switch, mirror-mounting bracket	
<b>BRAKE</b>					
0120842	Brake control 167.60	9.5	DOT4/5.1	With parking brake for ATV	
0723165	Brake control 167.50.1 cni	12	DOT		

\* Find clutch switches page 59  
Maximum stroke | 13.8 mm  
Lever ratio | 1:4  
Tubing fitting | M 10x1

### 167 BRAKE MASTER CYLINDER

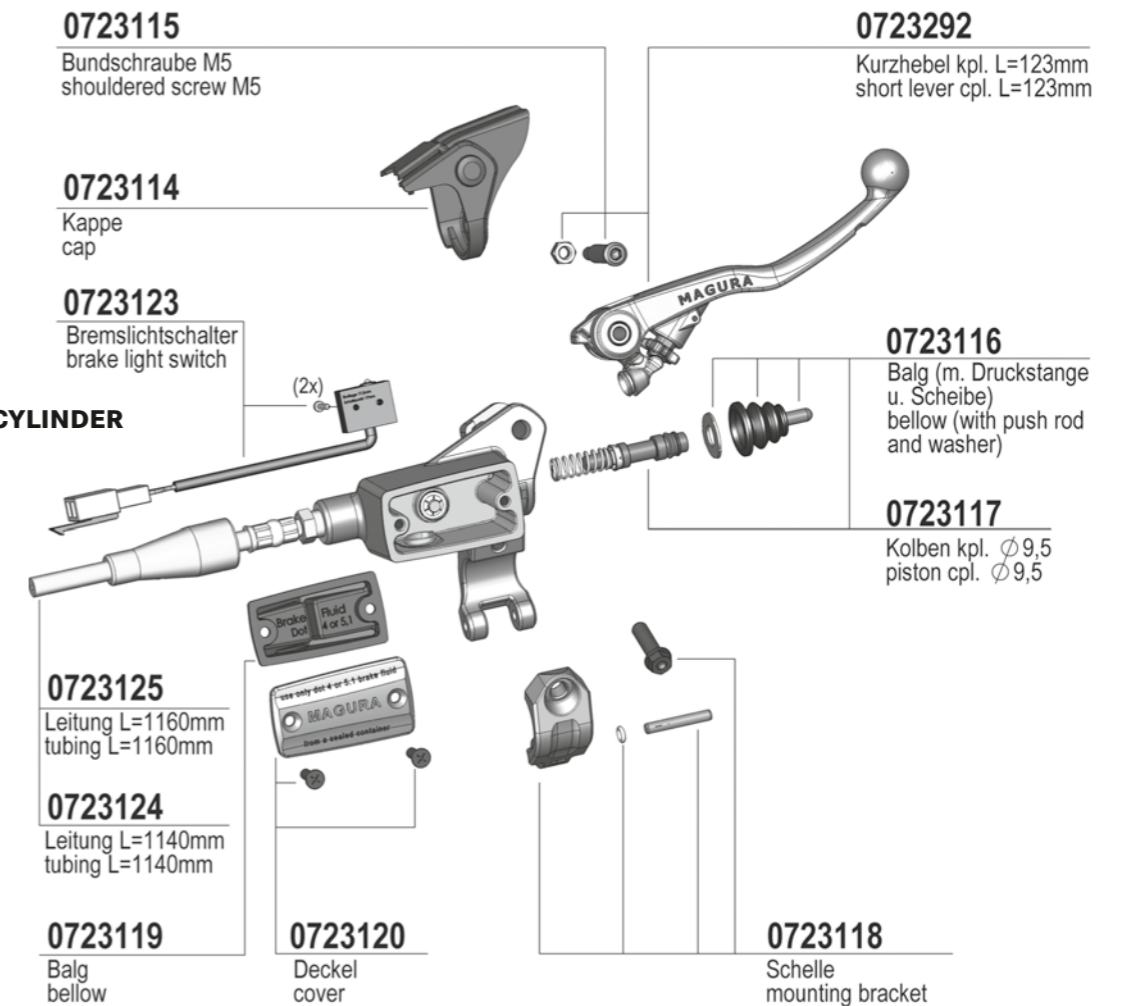



NO FADING

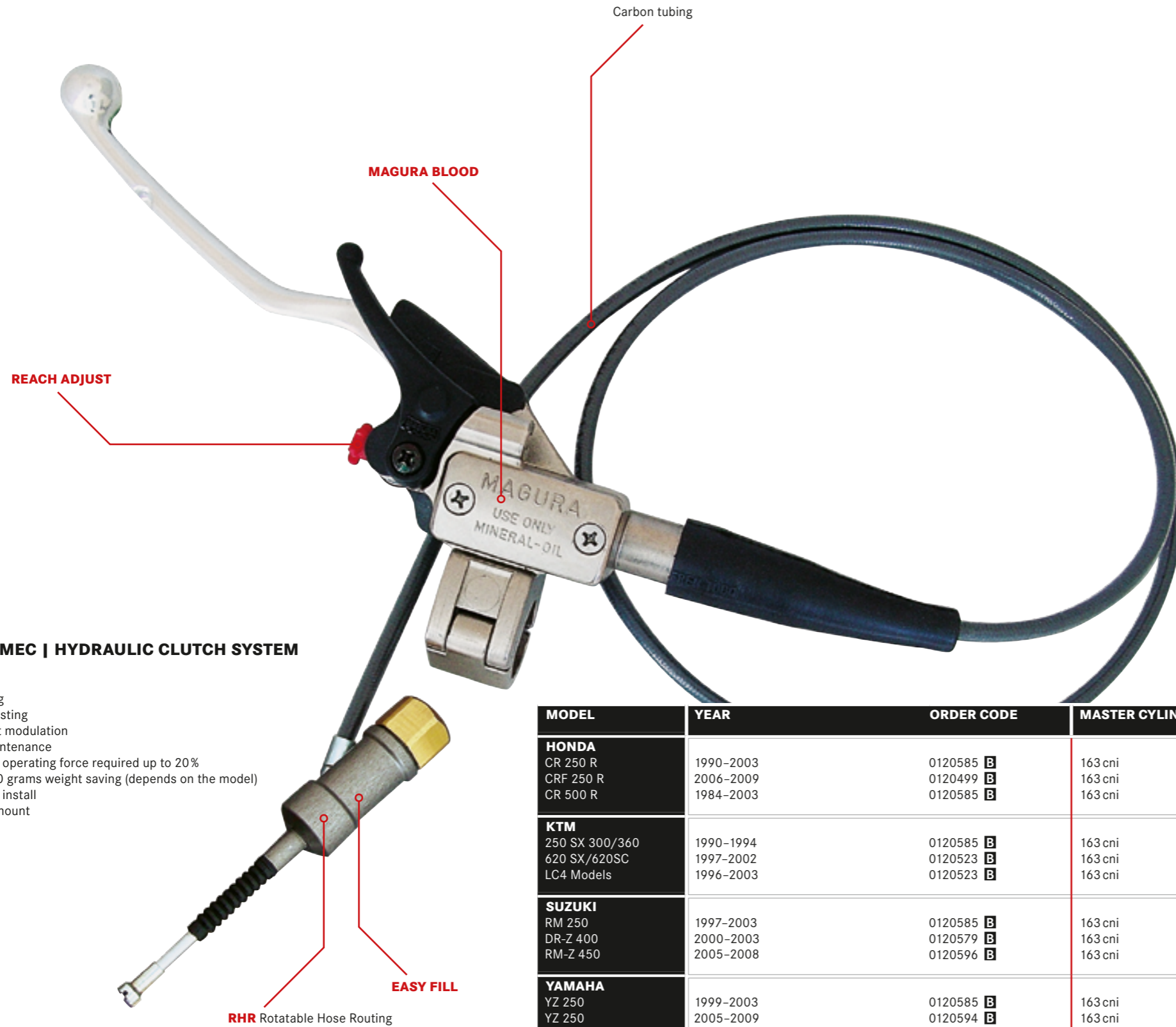

**163 HYMEC | HYDRAULIC CLUTCH SYSTEM**

- > No fading
- > Self-adjusting
- > Excellent modulation
- > Less maintenance
- > Reduced operating force required up to 20%
- > Up to 150 grams weight saving (depends on the model)
- > Ready to install
- > Easy to mount

**163 HYMEC | OFF-ROAD**

MAGURA HYMEC – An easy to install alternative to a mechanical clutch. This system replaces the clutch lever and cable – with a small lightweight hydraulic system for improved clutch control. The HYMEC ensures an easier operating pressure, a constant pressure point, no more cable adjustment and smooth clutch actuation to ensure the perfect take-off every time.

Clutch operation with the MAGURA hydraulic kick. The thousand-fold proven hydraulic clutch operating system for Motocross and Enduro. Superior technology which unites an abundance of unique advantages into one: No fading, superfine modulation, almost maintenance-free, automatic compensation for pad wear and up to 20% less actuating force! HYMEC provides a uniquely sensitive operation and significantly improves vehicle control. A weight saving of up to 150 grams is possible according to the model.

MODEL	YEAR	ORDER CODE	MASTER CYLINDER	HOSE LENGTH in mm	PISTON Ø in mm	ASSEMBLY SIZE	REPLACE SLAVE
<b>HONDA</b>							
CR 250 R	1990–2003	0120585 <b>B</b>	163 cni	1,045	9.5	52	0120648
CRF 250 R	2006–2009	0120499 <b>B</b>	163 cni	1,045	9.5	57	0120655
CR 500 R	1984–2003	0120585 <b>B</b>	163 cni	1,045	9.5	52	0120648
<b>KTM</b>							
250 SX 300/360	1990–1994	0120585 <b>B</b>	163 cni	1,045	9.5	52	0120648
620 SX/620SC	1997–2002	0120523 <b>B</b>	163 cni	1,045	10.5	50	0120648
LC4 Models	1996–2003	0120523 <b>B</b>	163 cni	1,045	10.5	50	0120648
<b>SUZUKI</b>							
RM 250	1997–2003	0120585 <b>B</b>	163 cni	1,045	9.5	54	0120648
DR-Z 400	2000–2003	0120579 <b>B</b>	163 cni	1,120	10.5	57	0120655
RM-Z 450	2005–2008	0120596 <b>B</b>	163 cni	1,045	9.5	108	0120657
<b>YAMAHA</b>							
YZ 250	1999–2003	0120585 <b>B</b>	163 cni	1,045	9.5	52	0120648
YZ 250	2005–2009	0120594 <b>B</b>	163 cni	1,045	9	52	0120648
YZ 250 F	2002–2003	0120579 <b>B</b>	163 cni	1,120	10.5	57	0120655
YZ/WR 400 F	1998–1999	0120579 <b>B</b>	163 cni	1,120	10.5	57	0120655
YZ 426 F	2000–2002	0120579 <b>B</b>	163 cni	1,120	10.5	57	0120655
XT 660 R/X	All	0120586 <b>B</b>	163 cni	1,045	9.5	85	0120659

Maximum stroke | 10.5–11.5 mm  
Lever ratio | 1:4.6  
Slave cylinder piston | Ø 10.5 mm

Please find spare parts on pages 28/29



163 HYMEC | MASTER CYLINDER

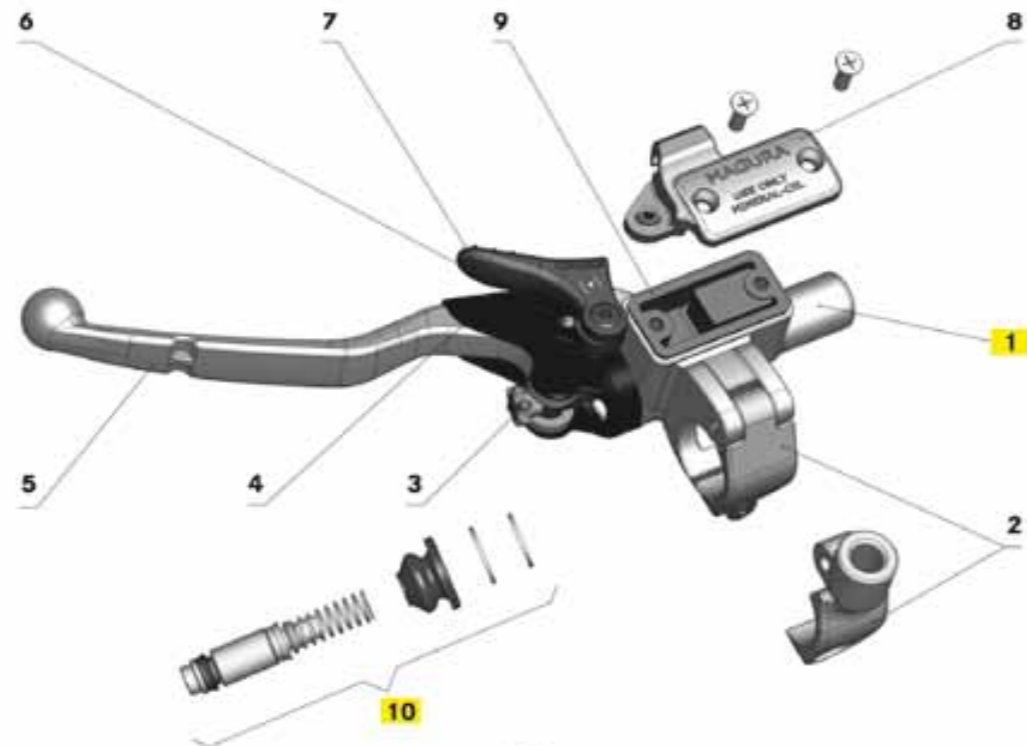

163 HYMEC | SLAVE CYLINDER

⚠ Slave cylinder seal-kits not available as spare parts!

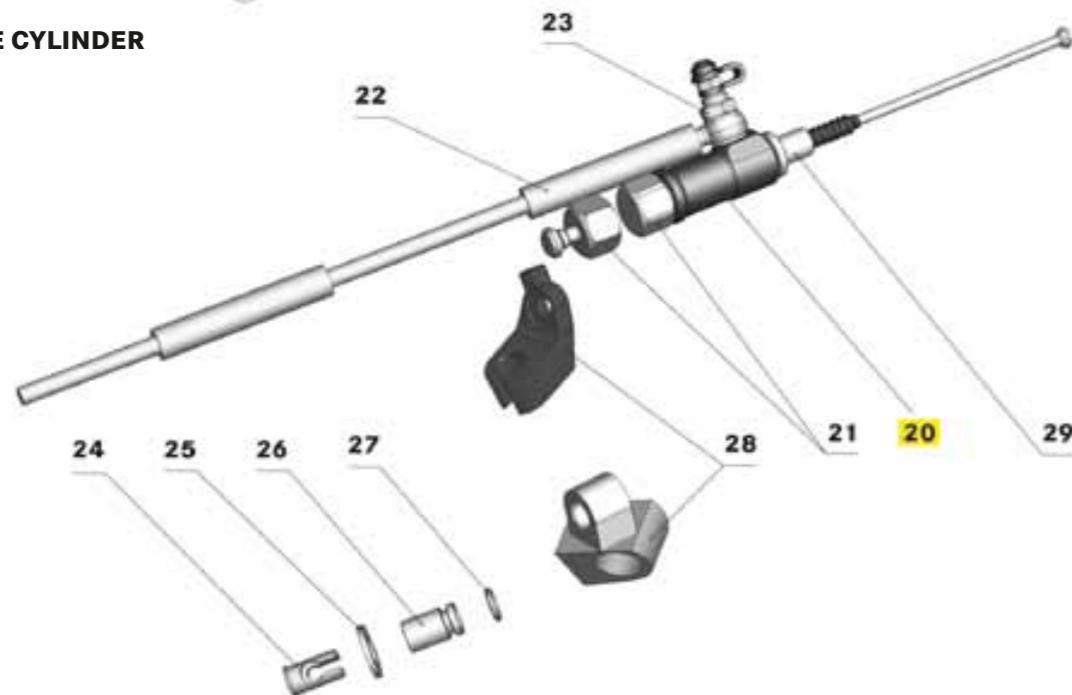

163 HYMEC | SPARE PARTS

POSITION	DESCRIPTION	ITEM CODE
1	Master cylinder*	Pages 30/31
2	Clamp with spiral spin Clamp for threaded mirror mounting M 10x1.25 mm Clamp black with spiral spin Clamp schwarz for threaded mirror mounting M 10x1.25 mm	0720546 0720543 0720503 <b>B</b> 0722026
3	Adjuster wheel for lever, red (packaging unit 10 pcs.)	0720572
4	Protection cover for lever	0429633
5	Long lever blade with accessories and coil spring l = 147 mm Short lever blade with accessories and coil spring l = 123.5 mm Special lever blade f. master cylinders with bigger space l = 152 mm	0720598 0720600 0722021
6	Screw for lever	0720504
7	Deco lever black Choke lever black Choke lever red	0720552 0722118 0722312
8	Cover without deco-/choke lever Cover with thread for deco lever Cover with hole for deco lever Cover for choke lever Cover black without deco-/choke lever	0720544 0720553 0720559 0722139 0720500
9	Reservoir membrane	0720560
10	Master piston Ø	9.0 mm 0722027 9.5 mm 0720555 10.5 mm 0720499
20	Slave cylinder	Pages 22/23
21	Cap bronze anodised Cap with stud bronze anodised	0430217 0430998
22	Tubekit PA with accessories l = 1.045 mm Tubekit PA with accessories l = 1.120 mm Tubekit carbon with accessories l = 1.120 mm Tubekit CARBON with accessories l = 1.045 mm Tubekit PA with accessories l = 1.500 mm	0720549 0720550 0722137 0722138 0722679
23	banjo bolt with bleeding valve for carbon tubings M 6x16.5 mm	0722136
24	Sleeve	0430224
25	Disc	0451530
26	Sleeve for HYMEC 0120594 Sleeve for HYMEC 0120585	0430985 0430987
27	O-ring (needed for sleeve 0430985 and 0430987)	0488255
28	Mounting adapter Honda CRF 450 R, model year 2004 Mounting adapter Suzuki RM-Z 250, Kawasaki KXF 250 Mounting adapter Kawasaki KX 450 F, model year 2006	0430220 0430240 0430997
29	Support	0412310
30	MAGURA-Blood 100 ml MAGURA-Blood 1 Liter	0721820 0721821

\* If the master cylinder with decompression lever or choke lever is required, you have to order additionally Pos. 8 and Pos. 7.





NICKEL-PLATED

BLACK PAINTED SURFACE



FINAL EDITION

### 163 cni\* HYDRAULIC CLUTCH MASTER CYLINDER

\*cni | chemical nickel-plated surface

Hydraulic clutch lever, one piece aluminium cylinder with reservoir, forged alloy lever blade, pressure point adjustable and reach adjustable, easy to fix with clamp, cylinder and lever blade pivot protected against foreign elements with rubber cap. Available for using mineral oil or brake fluid.

ORDER CODE	MODEL	PISTON Ø in mm	DESCRIPTION	APPLICATION
0120591	Master cylinder 163.5	9	Long lever blade, with decompression lever	KTM 4-Stroke Racing, from model year 2004 HYMEC version
0120593	Master cylinder 163.5	9	Short lever blade, without decompression lever	KTM 65/85 model year 2005 + 2006
0120465	Master cylinder 163.4	9.5	Long lever blade, with decompression lever	KTM 4-Stroke Racing, up to model year 2003, KTM LC4 Rallye, KTM SMR 660, Husaberg
0120554	Master cylinder 163.4	9.5	Long lever blade, with decompression lever, thread for clutch switch <sup>1)</sup>	Husqvarna from model year 2005
0120555	Master cylinder 163.4	9.5	Long lever blade, with decompression lever, thread for safety start switch <sup>1)</sup> , mirror mounting bracket	Husqvarna from model year 2005
0120580	Master cylinder 163.4	9.5	Long lever blade, without decompression lever	HYMEC version
0120581	Master cylinder 163.4	9.5	Short lever blade, without decompression lever	HYMEC version
0120577	Master cylinder 163.40	9.5	Special lever blade, without decompression lever, thread for safety start switch <sup>1)</sup> , mirror mounting bracket, big space <sup>2)</sup>	HYMEC version
0120607	Master cylinder 163.40	9.5	Special black lever blade, without decompression lever, with safety start switch, big space <sup>2)</sup>	KTM LC8
0120615	Master cylinder 163.40	9.5	Special black lever blade, without decompression lever, with safety start switch, big space <sup>2)</sup>	
0120573	Master cylinder 163.3	10.5	Long lever blade, with decompression lever, mirror mounting bracket	KTM LC4 SM/SXC
0120575	Master cylinder 163.30	10.5	Special lever blade, with decompression lever, thread for safety start switch <sup>1)</sup> , mirror mounting bracket, big space <sup>2)</sup>	KTM LC4 Duke, Adventure 640 E HYMEC version
0120571	Master cylinder 163.3	10.5	Long lever blade, without decompression lever	HYMEC version
0120570	Master cylinder 163.3	10.5	Short lever blade, without decompression lever	KTM 125/200, KTM 250/300 up to my. 2003
0120587	Master cylinder 163.3.10	10.5	Short lever blade, for brake fluid use only	

my. = model year

<sup>1)</sup> Find clutch switch page 59<sup>2)</sup> Increased distance for street bikes to allow enough space for switchgear unit.

FINAL EDITION

⚠ Only for mineral oil!

### 163 Is\* HYDRAULIC CLUTCH MASTER CYLINDER

\*Is | black painted surface

ORDER CODE	MODEL	PISTON Ø in mm	DESCRIPTION	APPLICATION
0020582	Master cylinder 163.4	9.5	Long black lever blade, without decompression lever	Cannondale ATV
0120572	Master cylinder 163.3	10.5	Long lever blade, without decompression lever	
0120576	Master cylinder 163.30	10.5	Special lever blade, with decompression lever, thread for safety start switch <sup>1)</sup> , big space <sup>2)</sup>	KTM LC8
0120603	Master cylinder 163.40	9.5	Special lever blade, without decompression lever, safety start switch <sup>1)</sup> , big space <sup>2)</sup> , mirror mounting bracket	BUELL

Maximum stroke | 13.5mm  
Lever ratio | 1:4,6  
Tubing fitting | M 10x1

<sup>1)</sup> Find clutch switches page 59<sup>2)</sup> Increased distance for street bikes to allow enough space for switchgear unit





**ON-ROAD**

ERGONOMICALLY DESIGNED

NO FADING





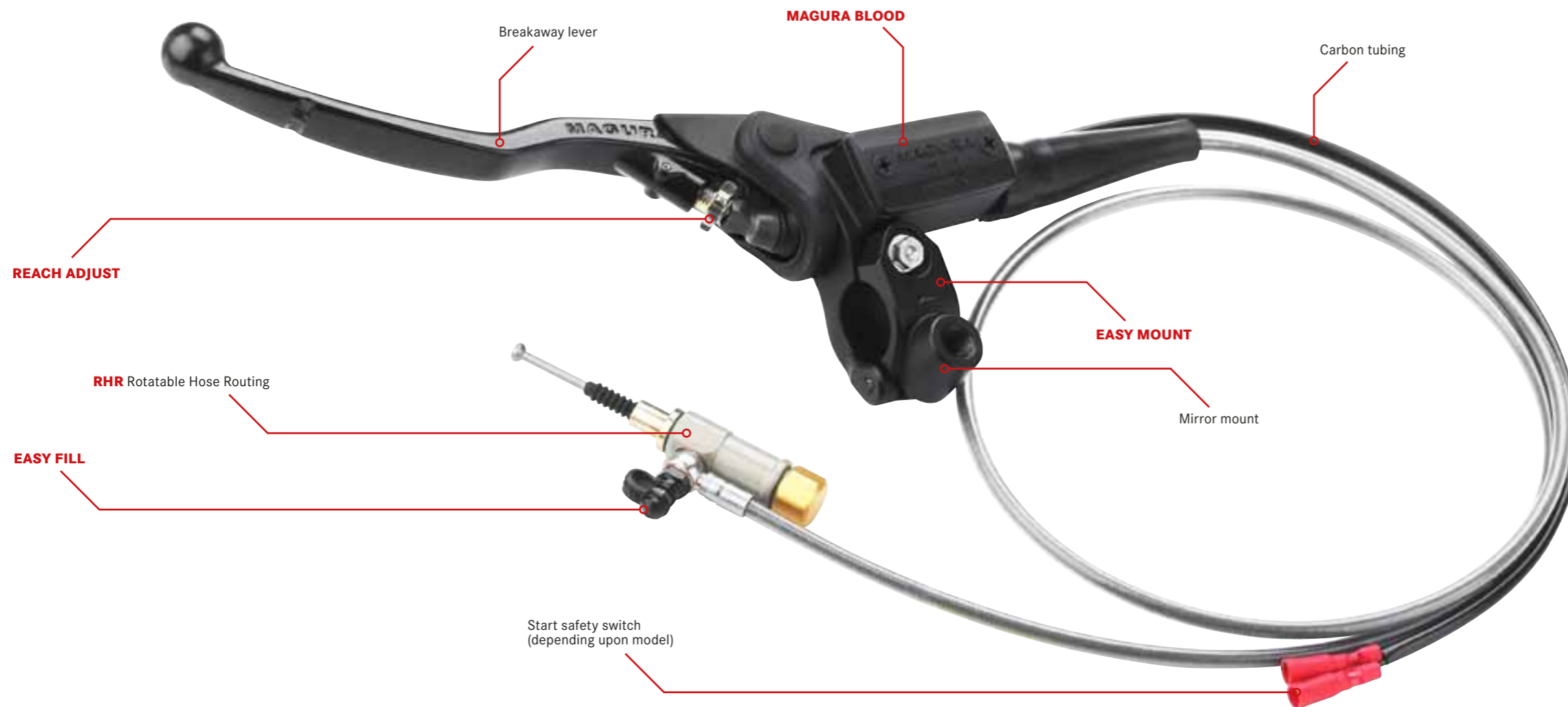

If you are the owner of an older model HYMEC clutch activation an require a replacement slave cylinder but are not sure of the correct order number you will find some information on page 30 which provides an overview of the available options and should help to find the correct part.

**STREET-HYMEC**

MAGURA HYMEC - An easy to install alternative to a mechanical clutch. This system replaces the clutch lever and cable - with a small lightweight hydraulic system for improved clutch control. The HYMEC ensures an easier operating pressure, a constant pressure point, no more cable adjustment and smooth clutch actuation to ensure the perfect take-off every time.

HYMEC significantly improves vehicle performance - it allows the user to feel the point where the clutch releases and actuates. This product has been developed over many years and been tested under the toughest conditions possible in the world of motorcycle Off-Road sport. It has been used by world champion riders who all agree as to the benefits but it is just as useful to the complete novice who stalls at the traffic lights. Due to demand MAGURA now offers the HYMEC system for various road going motorcycles.

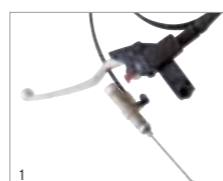

MODEL	YEAR	ORDER CODE	MASTER CYLINDER	HOSE LENGTH in mm	PISTON Ø in mm	ASSEMBLY SIZE	REPLACE SLAVE
<b>BMW</b> F 800 (all models)	Available to order from spring 2013!						
<b>BOMBARDIER</b> DS 650 ATV	2004-2009	0120524 <b>B</b>	163 cni <sup>1)</sup>	1,045	9.5	73	0120653
<b>BUELL</b> XB models	2003-2009	0120599	163 Black <sup>1)</sup>	1,500	9.5	102	0120624
<b>HONDA</b> CBF 600	2008-2013	2100001	167 Black <sup>2)</sup>	1,045	10.5	62	0120651
<b>KAWASAKI</b> Z 750 ER-6N Versys	From 2009	0120689	167 Black <sup>2)</sup>	1,045	9.5	65	0120651
	2006-2009	0120689	167 Black <sup>2)</sup>	1,045	9.5	65	0120651
	2007-2010	0120689	167 Black <sup>2)</sup>	1,045	9.5	65	0120651
<b>SUZUKI</b> SV 650	1999-2010	0120689	167 Black <sup>2)</sup>	1,045	9.5	65	0120651
<b>YAMAHA</b> SR 400/500 FZ 6	All	0120524 <b>B</b>	163 cni <sup>1)</sup>	1,045	9.5	73	0120653
	2007-2010	0120689	167 Black <sup>2)</sup>	1,045	9.5	65	0120651
<b>YAMAHA ATV</b> Banshee add for this model	Up to 2003	0120579 <b>B</b> 0720544 <b>B</b>	163 cni <sup>1)</sup>	1,120	10.5	57	0120655
	From 2004	0120513 <b>B</b>	163 cni <sup>1)</sup>	1,045	10.5	56	0120655

Maximum stroke | 10.5-11.5 mm <sup>1)</sup> 163 spare parts page 29  
 Lever ratio | 1:4 <sup>2)</sup> 167 spare parts page 24  
 Slave cylinder piston | Ø 10.5 mm



### 190ebz\* MASTER CYLINDER

\*ebz | bronze anodised

#### Have something nice in your hands

Looks fantastic, feels great – MAGURA RADIAL 190 – operate your brake and clutch like the professionals! CNC-machined from one piece, requires less space on the handlebars and excellent brake and clutch modulation. Radial pump 190. Perfect for racing!

CNC MACHINED

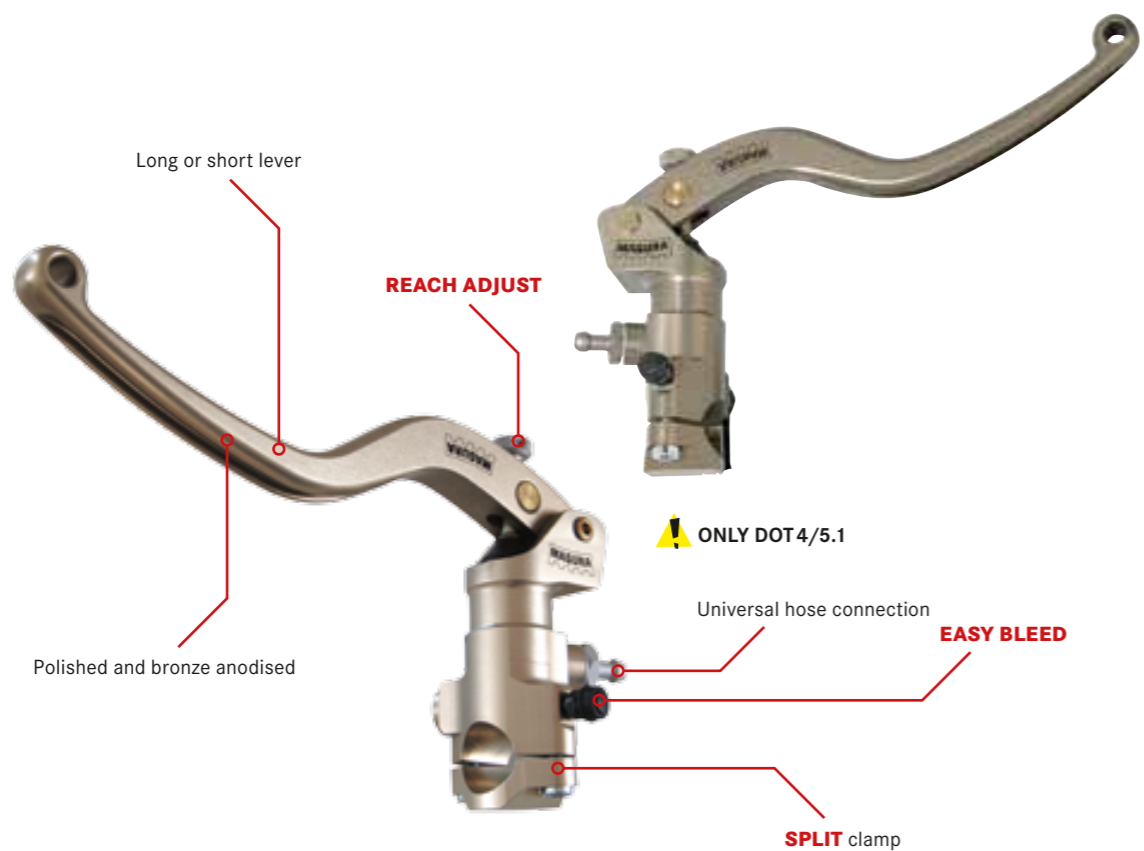

ORDER CODE	MODEL	PISTON Ø in mm	DESCRIPTION/ APPLICATION
<b>BRAKE</b>			
0120429 <b>B</b>	Radial brake cylinder	13	With long lever blade
0120436 <b>B</b>	Radial brake cylinder	13	With short lever blade for racing
0120432 <b>B</b>	Radial brake cylinder	16	With long lever blade
0120439 <b>B</b>	Radial brake cylinder	16	With short lever blade for racing
0120438 <b>B</b>	Radial brake cylinder	20	With short lever blade for racing
<b>CLUTCH</b>			
0120441 <b>B</b>	Radial clutch cylinder	13	With long lever blade

**Features and benefits**

- > For big bikes, super bikes and supermotos!
- > CNC-machined from one piece!
- > High-end aerospace aluminium
- > Optimized lever ratio
- > Direct pressure point
- > Much more sensitive and powerful brake and clutch performance
- > Space-saving design
- > Polished and bronze anodised!

All in all : Impressive combination of handling and function

For handlebars Ø | 22 mm  
Max. stroke | 11 mm  
Lever ratio | 1:7,2

### 190ebz\* MASTER CYLINDER

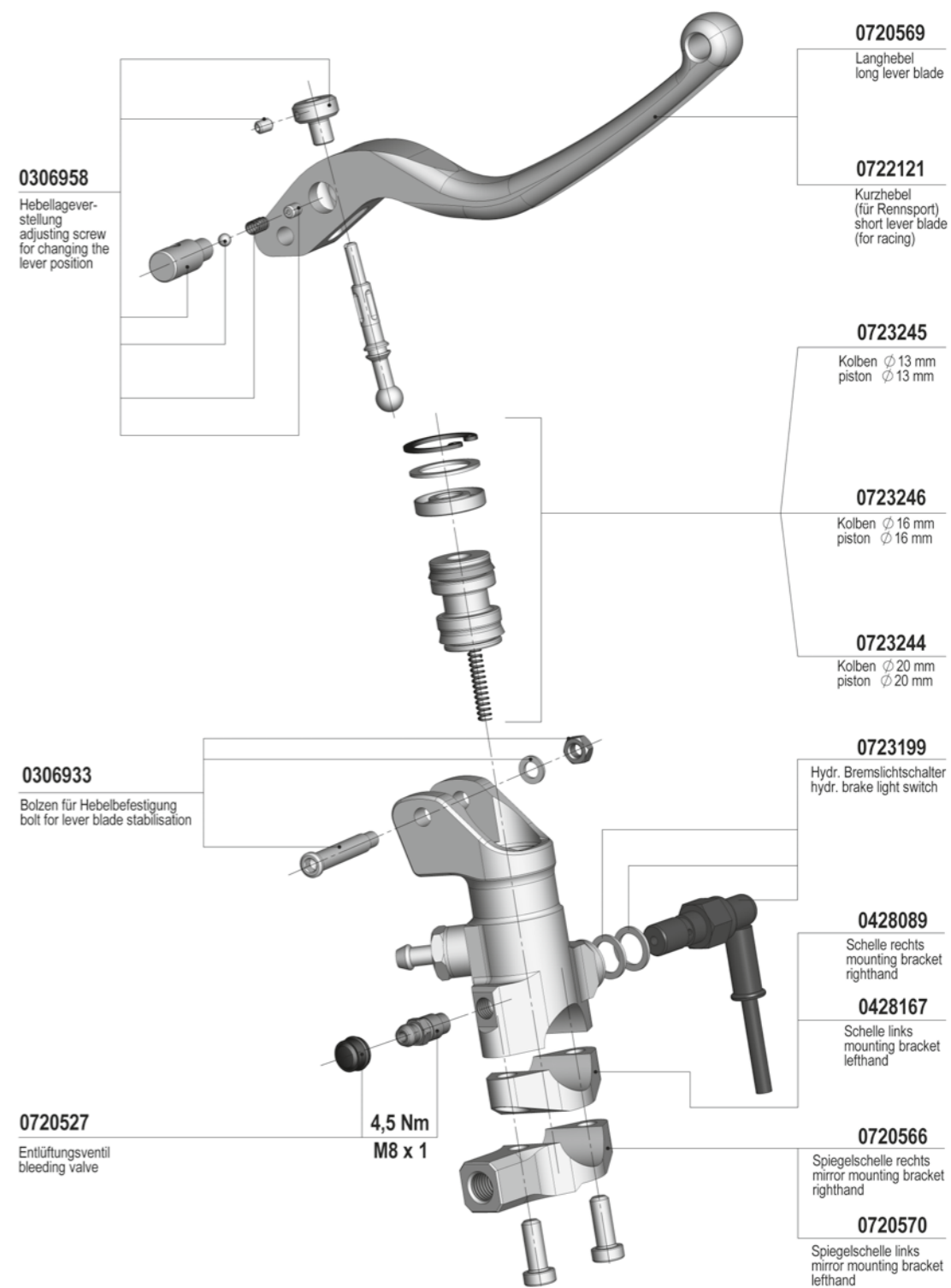



FORGED

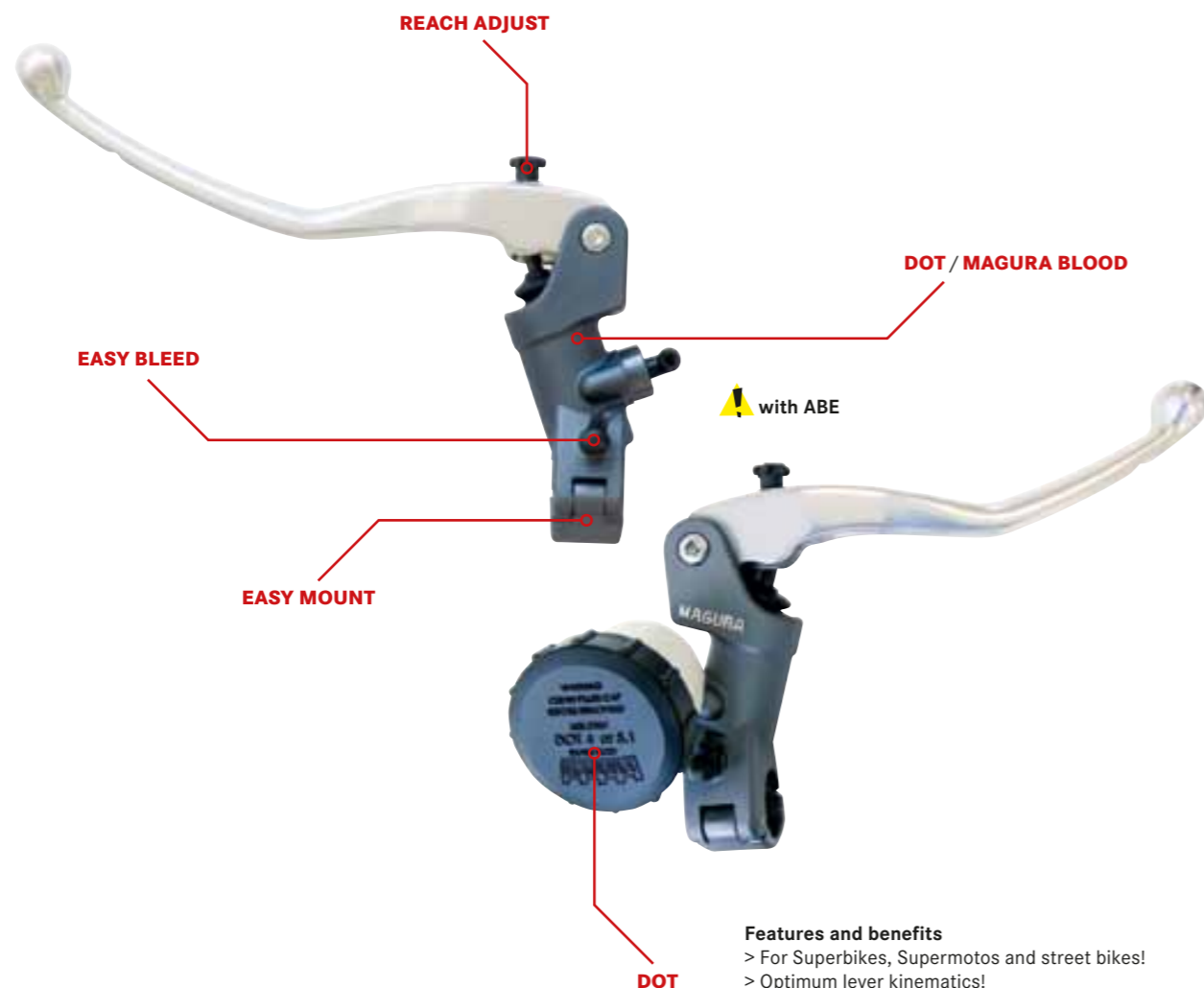

- Features and benefits**
- > For Superbikes, Supermotos and street bikes!
  - > Optimum lever kinematics!
  - > Brake lever reach individually adjustable!
  - > Manufactured to highest quality standards!
  - > The lever and cylinder are forged parts!
  - > Direct pressure point!
  - > Sensitive and powerful braking and clutch operation!
  - > Space-saving design!
  - > Excellent price/performance ratio!
- In short: The complete brake master in terms of feeling, fun and comfort.

**195 MASTER CYLINDER**

This highly compact radial fitting is the latest MAGURA brake and clutch concept. Through its slanted pump arrangement, RADIAL 195 offers ideal installation options. Like all MAGURA products, RADIAL 195 is robust, durable and a real technological treat. The brake cylinder is supplied with a pre-assembled brake light switch. Spares include reservoirs with fittings and two optional lever lengths.

ORDER CODE	MODEL	PISTON Ø in mm	COLOR	DESCRIPTION/ APPLICATION
<b>BRAKE</b>				
0120802	Radial brake cylinder	11	Anthracite	With short lever blade
0120794	Radial brake cylinder	12	Anthracite	With short lever blade
0120791	Radial brake cylinder	13	Anthracite	With short lever blade
0120792	Radial brake cylinder	16	Anthracite	With short lever blade
0120793	Radial brake cylinder	20	Anthracite	With short lever blade
<b>CLUTCH</b>				
0120643	Radial clutch cylinder	13	Anthracite	Only for DOT, with long lever blade
0120641	Radial clutch cylinder	13	Aluminium	Only for mineral oil, with long lever blade, OEM KTM DUKE 950
0120691	Radial clutch cylinder	12	Anthracite	Only for mineral oil, with long lever blade, compatible with MAGURA-HYMEC

Weight | approx. 280g  
Lever ratio | 1:5  
Reach adjust | 16mm

**195 MASTER CYLINDER**

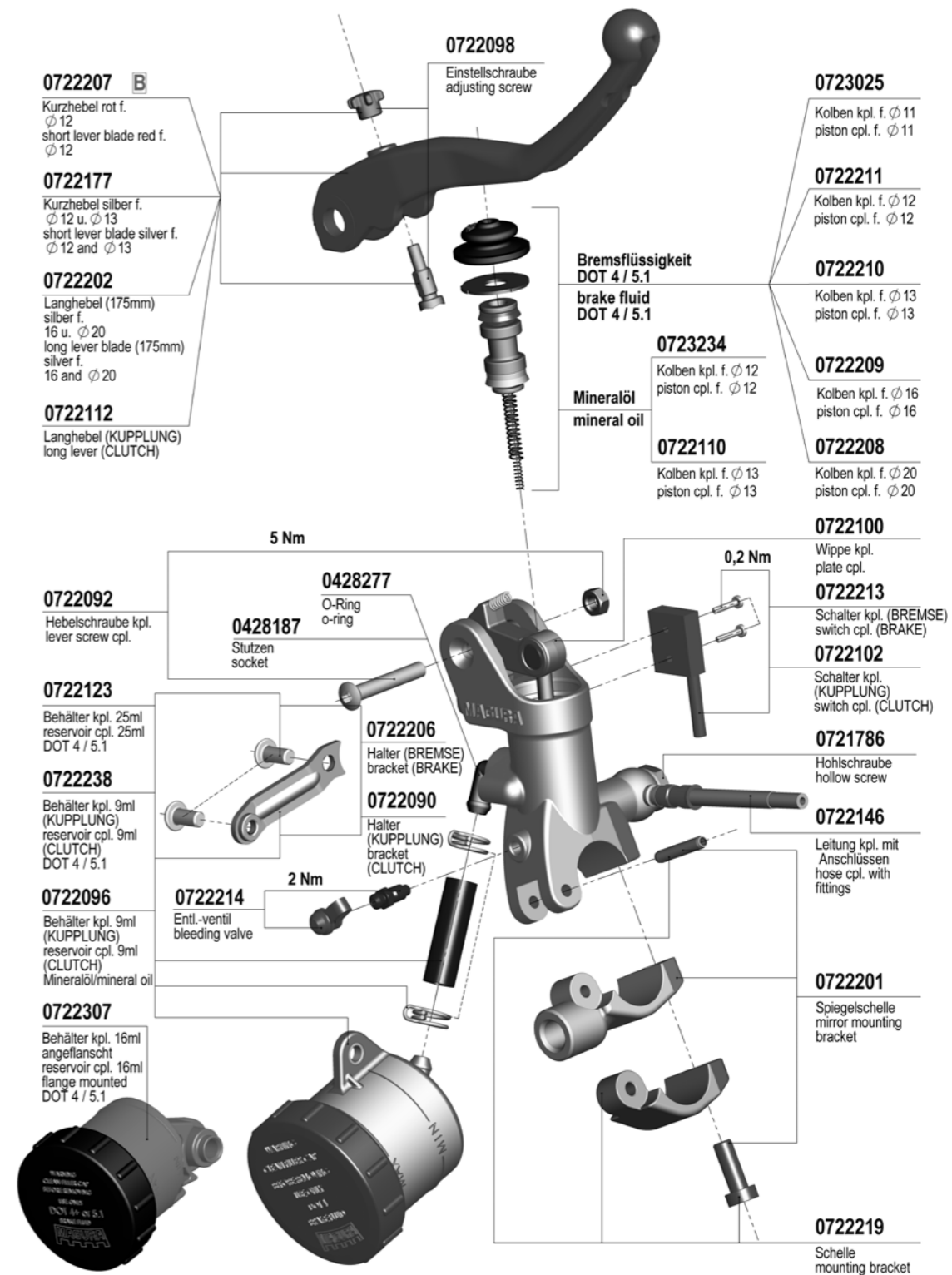





ORIGINAL MAGURA SPARE PARTS

MAXIMUM PERFORMANCE

QUALITY MADE IN GERMANY

**SPARE PARTS FOR  
BRAKE SYSTEMS**







**90 YEARS  
OF TRADITION**



**CLASSICS**





### 73 SPORT BRAKE LEVER

Sport brake lever for mechanical brakes (drum brakes). Light weight forged alloy black split perch clamp and polished Eurostyle ball-end blade, 160 mm long, Ø 8.2 mm hole for rearview mirror.

ORDER CODE	MODEL	DESCRIPTION/APPLICATION	ACCESSORIES
0116933	B-lever 73.2	Thread 1/4" for brake light switch (0128496)	Nipple barrel, solder nipple, adjusting screw
0116934 B	B-lever 73.202	Dual-cable pull, with equalizer, to operate two drum brakes	Solder nipple

Technical data: Cable pull 20 mm | thread M7 for adjusting screw



### 74 SPORT CLUTCH LEVER

Sport clutch lever, light weight forged alloy black split perch clamp and polished, Eurostyle ball-end blade, 160 mm long, Ø 8.2 mm hole for rearview mirror.

ORDER CODE	MODEL	DESCRIPTION/APPLICATION	ACCESSORIES
0116933	C-lever 74.1	Cable pull 20 mm at 3.9 ratio, HUSQVARNA, KTM, MAICO etc.	Nipple barrel, solder nippel, adjusting screw
0116934 B	C-lever 74.1	As above except black anodized blade	Nipple barrel, solder nipple, adjusting screw

Technical data: Various cable pull at different ratios. See descriptions lefthand Thread M7 for cable adjusting screw



### 101 CLUTCH LEVER

Clutch lever with clamp for tube-Ø 22 mm, with thread M 6 for adjusting screw or supporting hole Ø 6.5 mm for cable.

ORDER CODE	MODEL	DESCRIPTION/APPLICATION	ACCESSORIES
0117380	C-lever 101.2.9	Black shank with thread for adjusting screw, black fibre reinforced lever blade, SPARTA	Adjusting screw, barrel, nipple
0117421	C-lever 101.4.8	Black shank with thread for adjusting screw, polished aluminium lever blade with stop notch	Barrel, nipple, s-nipple
0117496	C-lever 101.7.9	Black shank with supporting hole and thread for switch, black fibre reinforced lever blade with pull back spring, PUCH, TOMOS	Barrel, nipple
0117514	C-lever 101.8.9	Black shank with thread M 6 and thread for switch, black fibre reinforced lever blade with pull back spring	Adjusting screw, barrel, nipple

Technical data: Cable pull | 18 mm, length of lever blade 125 mm, blade with ball end Ø 18 mm



### 103 BRAKE-/CLUTCH LEVER WITH DECOMPRESSION LEVER

Double-shank for brake lever and starting clutch lever with clamp, hole Ø 8.1 mm for rear-view mirror, black fibre reinforced starting clutch lever blade.

ORDER CODE	MODEL	DESCRIPTION/APPLICATION	ACCESSORIES
0118771	B/C-lever 103.21.8	Black shank with supporting hole Ø 6.5 mm, black fibre reinforced lever blade	Barrel, nipple
0118778	B/C-lever 103.21.8	Black shank with supporting hole Ø 6.5 mm, black fibre reinforced lever blade	-

Technical data: Cable pull | brake lever blade 18 mm, start lever blade 15 mm



### 108 BRAKE LEVER

Brake lever righthand for tube-Ø 22 mm, cable supporting hole, alloy lever blade or reinforced fibre lever blade.

ORDER CODE	MODEL	DESCRIPTION/APPLICATION
0119570	B-lever 108.4.9	Righthand, black fibre reinforced lever blade, thread for brake light switch, pull back spring, supporting hole

Technical data: Cable pull | 18 mm





### 155 THROTTLE TWIST GRIP WITH MECH. BRAKE

Straight pulley throttle twist grip, dual cable pull, with forged brake lever, bevel wheel drive, switch housing and thread M8x1 for brake light switch. Fitting clutch lever model 156.

ORDER CODE	MODEL	DESCRIPTION/APPLICATION	ACCESSORIES
0120050	Throttle twist grip 155.3	BMW/5-models up to 8/74 and former models	Picture

Technical data: Cable pull | throttle 38+2 mm at a rotation of 160°, brake 20 mm

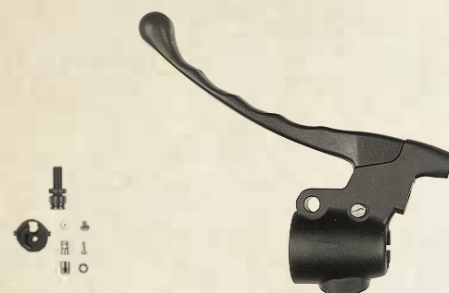

### 156 CLUTCH LEVER

Clutch lever with forged lever, black shank with clamp and hole for rear-view mirror, thread M8x1 for interrupting switch, grippy lever, black switch housing. Fitting throttle twist grip model 155.

ORDER CODE	MODEL	DESCRIPTION/APPLICATION	ACCESSORIES
0120070	C-lever 156.3	BMW/5-models up to 8/74	Picture

Technical data: Cable pull | 26 mm



### 159 CLUTCH LEVER

Clutch control with a forged black lever blade, black housing with switch support for HELLA-switches, thread for adjusting screw, possibility to fix a choke lever blade. Fitting throttle twist grip models 157, 286.

ORDER CODE	MODEL	DESCRIPTION/APPLICATION	ACCESSORIES
0120261	Clutch lever 159.2	With mounted choke lever blade, BMW-boxer, all BMW-models from 9/81 up to 8/84, R 80 G/S, R 80 from 9/84	Picture
0120341	Clutch lever 159.11	Without choke lever blade, BMW-models R 80, R 100/6 up to 9/74 and /7-models	-

Technical data: Cable pull | clutch 22 mm, choke 26 mm

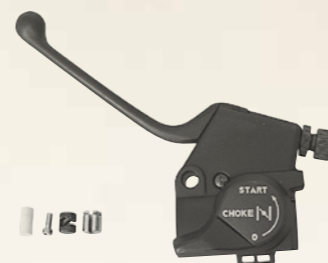

### 160 CLUTCH LEVER

Clutch control with a forged lever blade, black painted housing with integrated choke-lever and thread M 10x1 for cable adjusting.

ORDER CODE	MODEL	DESCRIPTION/APPLICATION
0120354	Clutch lever 160.5	Black lever blade, BMW K 75 (model year '86-'95)
0120353	Clutch lever 160.4	Black lever blade, OEM-Equipment: BMW K 1, K 1100 RS, K 1100 LT, R 1100 RS, R 1100 GS, R 850 R till model year 2002, R 1100 R, R 1100 RT
0550901	Clutch lever 160.4	As above, but with alloy-colored lever blade and only OEM-equipped on special models

Technical data: Cable pull | clutch 24.1 mm choke 22.5 mm



### 225 HYDRAULIC BRAKE AND CLUTCH LEVER

**Features and benefits**  
Hydraulic brake and clutch lever, black painted housing with a (22 mm) clamp, polished alloy lever, thread for brake light switch and hole Ø 8.1 mm or thread M 8 for rear-view mirror, thread M 10 x1, plastic brake fluid reservoir. Obtainable as righthand and lefthand model. Fitting brake and clutch switch see No. 19/20 page 59.

ORDER CODE	MODEL	PISTON Ø in mm	DESCRIPTION/APPLICATION
<b>RH</b>			
0122000	B-lever 225.2	13	Polished lever, hole-Ø 8.1 mm for mirror
0122020	B-lever 225.4	16	Hole-Ø 8.1 mm for mirror
<b>LH</b>			
0122110	K-lever 225.52	13	Polished lever, hole-Ø 8.1 mm for mirror
0122130	K-lever 225.54	16	Hole-Ø 8.1 mm for mirror

Technical data: Stroke | 12 mm





### 234 THROTTLE TWIST GRIP WITH MECHANIC BRAKE

One cable pull with brake lever blade and integrated choke lever blade for F & S-wheel hub engine, black painted housing with thread for adjusting screw, black fibre reinforced lever blade.

ORDER CODE	MODEL	DESCRIPTION/APPLICATION	ACCESSORIES
<b>0100270 B</b>	Throttle twist grip 234.3.9	Without pull back spring in the grip tube, SACHS (Sachsonette)	Barrel, nipple, s-nipple, solder nipple

Technical data: Cable pull | throttle 18 mm, brake 15 mm choke up to 1:16 mm, total 27 mm



### 273 THROTTLE TWIST GRIP WITH MECHANIC BRAKE

Straight pulleye throttle twist grip with brake lever blade, one cable pull (possibility for outer attachment), black painted housing with supporting hole Ø 6.5 mm or adjusting screw for cable, polished alloy lever or fibre reinforced lever blade with or without pull back spring, sliding clamp for screwing or for solder nipple.

ORDER CODE	MODEL	DESCRIPTION/APPLICATION	ACCESSORIES
<b>0123953</b>	Throttle twist grip 273.6.8	Black housing with thread for brake light switch, sliding clamp, PUCH	Barrel, nipple
<b>0123954</b>	Throttle twist grip 273.6.8	As above, but without accessories	-
<b>0124225 B</b>	Throttle twist grip 273.56.8	Black housing with thread for brake light switch, supporting hole, pull back spring, sliding clamp for solder nipple, grip with longitudinal rips, PUCH	-

Technical data: Cable pull | throttle 21 mm at a rotation of 104°, brake 18 mm



### 270 THROTTLE TWIST GRIP WITH MECHANIC BRAKE

Rotation pulley throttle twist grip with alloy or fibre reinforced brake lever blade, one cable pull, closed housing (possibility for outer cable attachment), with pull back spring inside the grip tube.

ORDER CODE	MODEL	DESCRIPTION/APPLICATION	ACCESSORIES
<b>VERSIONS WITHOUT DECOMPRESSION LEVER BLADE</b>			
0101541	Throttle twist grip 270.9.8	Black housing with thread for brake light switch, polished alloy lever blade, KTM	Barrel, nipple, s-nipple
0101550	Throttle twist grip 270.9.9	Black housing with thread for brake light switch, black fibre reinforced lever blade, SACH	Barrel, nipple, s-nipple
0101590	Throttle twist grip 270.11.9	Black housing with thread for brake light switch and adjusting screw, black fibre reinforced lever blade, without pull back spring inside the grip tube, nobbed grip, SACHS	Barrel, nipple, s-nipple, adjusting screw
0101591	Throttle twist grip 270.11.9	As above, but grip with longitudinal rips, SACHS	Barrel, nipple, s-nipple, adjusting screw
<b>VERSIONS WITH DECOMPRESSION LEVER BLADE</b>			
0101821	Throttle twist grip 270.52.8	Black housing, pull back spring and decompression lever blade, KTM, SACHS, SPARTA, MONARK	Barrel, nipple, s-nipple, solder nipple
0102133	Throttle twist grip 270.66.9	Black housing with thread for brake light switch, black fibre reinforced lever blade	Barrel, nipple, s-nipple

Technical data: Cable pull | throttle 26 mm at a rotation of 92°, brake 18 mm



### 286 THROTTLE TWIST GRIP WITH MECHANIC BRAKE

Throttle twist grip with brake lever for single and dual cable pull, (cam with chain), forged black lever, black painted housing with thread M 10x1 and threat M8x1 for brake light switch, fits with HELLA-switches, rectangular reservoir, without grip tube. Please order the fitting grip tube order code 0312803 or the fitting heated grip separate.

ORDER CODE	MODEL	PISTON Ø in mm	DESCRIPTION/APPLICATION	ACCESSORIES
<b>0125310</b>	Throttle twist grip 286.2	16	Single cable pull, BMW all models from 8/80 up to 8/81 with 2 brake discs	Lens countersunk screw, cam, solder nipple
<b>0125321</b>	Throttle twist grip 286.3 without grip tube	12	Single cable pull, BMW all models from 9/81 up to 8/84 with 1 brake disc, R 80 G/S	Lens countersunk screw, cam, solder nipple
<b>0125331</b>	Throttle twist grip 286.4 without grip tube	15	Single cable pull, BMW-boxer all models from 9/81 up to 8/84 with 1 brake disc	Lens countersunk screw, cam, solder nipple
<b>0125350</b>	Throttle twist grip 286.12	16	Cable pull 40 mm, single cable pull, BMW-boxer all models from 8/80 up to 8/81 with 2 brake discs and a Ø 40 mm carburettor	Lens countersunk screw, cam, solder nipple
<b>0225342</b>	Throttle twist grip 286.21 without grip tube	13	Dual cable pull, BMW-boxer R 80 with 2 brake discs	Lens countersunk screw
<b>0125348</b>	Throttle twist grip 286.25 without grip tube	14	Dual cable pull, black lever blade, BMW-boxer R80 from 9/84 with 1 brake disc	Lens countersunk screw

Technical data: Cable pull | 33 mm at a rotation of 110° or 40 mm at a rotation of 110° (model 286.12)





### 287 HYDRAULIC BRAKE CONTROL

Brake control with twist grip support for one straight cable, forged lever blade, connection thread M 10x1 and thread for brake light switch, fits with MERIT-switches, without grip tube.

ORDER CODE	MODEL	PISTON Ø in mm	DESCRIPTION/APPLICATION	ACCESSORIES
0125381	Brake control 287.5	13	BMW K 75 from 9/85, K 100 from 9/84	Lens countersunk screw
0225382	Brake control 287.5	13	As above, but with polished lever	Lens countersunk screw
0225392	Brake control 287.9	13	BMW K 100 with ABS	Lens countersunk screw
0225393	Brake control 287.10	15	BMW K 100 with ABS	Lens countersunk screw

Technical data: Cable pull | 38 mm at a rotation of 110°

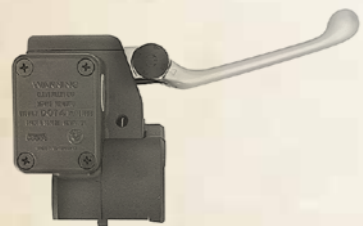

### 288 HYDRAULIC BRAKE CONTROL

Radial hydraulic brake control, with lever adjustment, M 10x1 brake tube fitting and integrated brake light switch.

ORDER CODE	MODEL	PISTON Ø in mm	DESCRIPTION/APPLICATION
0550942	Brake control 288.3.1	20	Black lever blade OEM-Equipment: BMW K 1, K 1100 RS, K 1100 LT, R 1100 RS, R 1100 GS, R 850 R till model year 2002, R 1100 R, R 1100 RT
0550943	Brake control 288.3.1	20	As above, but with alloy-colored lever blade and only OEM-equipped on special models

Technical data: Cable pull | 36 mm at a rotation of 90°

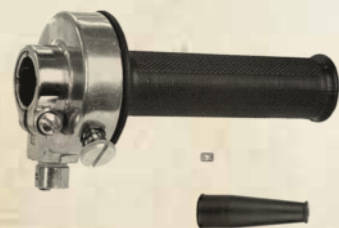

### 307 THROTTLE TWIST GRIP

Outer pulley throttle twist grip, single cable pull, straight cable up to 38 mm stroke, polished aluminium housing with trap door cover and adjusting screw for twist regulation, cable protection cover.

ORDER CODE	MODEL	DESCRIPTION/APPLICATION	ACCESSORIES
0125600	Throttle twist grip 307.1	For general using	Solder nipple, grub screw, cable protection cover
0125821 B	Throttle twist grip 307.6	Total stroke 84 mm at a rotation of 220°, special model for vehicles of handicapped bikers	Solder nipple, grub screw, cable protection cover

Technical data: Total stroke | 46 mm at a rotation of 115° for handlebars Ø 22 mm and 7/8"



### 309 THROTTLE TWIST GRIP

Throttle twist grip, one cable pull, with big rotation, two part housing of reinforced poly-carbon, protective sleeve.

ORDER CODE	MODEL	DESCRIPTION/APPLICATION	ACCESSORIES
0126003	Throttle twist grip 309.1	With grip "Street", SIMSON, SACHS, KTM, ZÜNDAPP	Cable support, cap, solder nipple

Technical data: Total stroke | 50 mm at a rotation of 213°



### 314 THROTTLE TWIST GRIP

Motocross throttle twist grip with single cable, parallel pull. DUO-settings (Motocross or Enduro). Cable routed over roller for ease of pull. Black reinforced poly carbon housing, pro-grid rubber grip, quick and easy cable change, without removing housing. Can be changed to enduro setting.

ORDER CODE	MODEL	DESCRIPTION/APPLICATION	ACCESSORIES
0730218	Twist grip set 314/029	In Motocross setting, with matching left grip	Solder nipple, rubber cable cover

Technical data: Total stroke | 48 mm at a rotation of 103°/91°



### 317 ELECTRIC THROTTLE TWIST GRIP

Housing made of glass-fibre reinforced plastics for tube-Ø 22 mm. Overall length 150 mm, max. current-carrying capacity 1 Watt, resistor and range of control of the potentiometer see below. Outer diameter of connection cable-Ø 6 mm, cable up to 3 seeses.

ORDER CODE	MODEL	DESCRIPTION/APPLICATION
0026471	Throttle twist grip/ Poti 317.2	5 kOhm-potentiometer, working rate 0-5 kOhm, cable length 800 mm
0026474	Throttle twist grip/ Poti 317.4	5 kOhm-potentiometer, working rate 0-5 kOhm, cable length 1800 mm
0026479	Throttle twist grip/ Poti 317.9	5 kOhm-potentiometer, working rate 0-5 kOhm, cable length 225 mm, with Molex-plug, for MuZ-Scooter "Charly"

Technical data: Rotation angle 75°





### 682 2-GEAR-SHIFT HANDLE GRIP

2-gear-shift handle grip, combined clutch lever, black painted housing with cable guide and cable adjusting screws, grip tube with cable adjusting screws, one or two cable pull.

ORDER CODE	MODEL	DESCRIPTION/APPLICATION	ACCESSORIES
0129912	Gear-shift handle grip 682.2.8	Shift 7.5 + 8, clutch cable pull 18 mm, lever blade with stop notch, nobbed grip, SACHS	Barrel, nipple, solder nipple, adjusting screws
0129918	Gear-shift handle grip 682.2.8	Shift 7.5 + 8, clutch cable pull 18 mm, lever blade with stop notch, nobbed grip, SACHS	-
0130139	Gear-shift handle grip 682.17.9	Shift 7 + 7, clutch cable pull 18 mm, black fibre reinforced lever blade, grip with long gated ribs, PUCH, SOLIFER, TUNTUR	Barrel, nipple, solder nipple, adjusting screws
0130260	Gear-shift handle grip 682.201.9	Shift 7.5 + 8, clutch cable pull 14.5 mm, black fibre reinforced lever blade, nobbed grip, SACHS	Barrel, nipple, solder nipple, adjusting screws

Technical data: Clutch cable pull 18 mm or 14.5 mm shift 1.+2. gear shown in the model description



### 683 3-GEAR-SHIFT HANDLE GRIP

3-gear-shift handle grip, combined clutch lever, black painted housing with cable guide and cable adjusting screws, one or two cable pull.

ORDER CODE	MODEL	DESCRIPTION/APPLICATION	ACCESSORIES
0130470	Gear-shift handle grip 683.1.9	Shift 6 + 5.3 + 8.7, clutch cable pull 18 mm, black painted housing, black fibre reinforced lever blade, nobbed grip, SACHS	Barrel, nipple, solder nipple, adjusting screws
0130720	Gear-shift handle grip 683.17.9	Shift 4.5 + 4.5 + 9, clutch cable pull 18 mm, black painted housing, black fibre reinforced lever blade, grip with long gated ribs, PUCH, MONARK, SOLIFER, TOMOS	Barrel, nipple, solder nipple, adjusting screws
0130830	Gear-shift handle grip 683.22.9	Shift 5.5 + 5.5 + 11, clutch cable pull 14.5 mm, black fibre reinforced lever blade without bracket, grip with long gated ribs, ZÜNDAPP	Barrel, nipple, solder nipple, adjusting screws
0131035	Gear-shift handle grip 683.201.9	Shift 6 + 5.3 + 8.7, clutch cable pull 14.5 mm, black painted housing, black fibre reinforced lever blade, nobbed grip, F & S-motors 505/3-gear, SACHS	Barrel, nipple, solder nipple, adjusting screws

Technical data: Clutch cable pull 18 mm or 14.5 mm shift 1.+2.+3. gear shown in the model description



### 700 MASTER BRAKE CYLINDER

Master brake cylinder for foot controlled rear disc brakes, tubing fitting M 10x1 to the brake caliper, without brake fluid reservoir, fitting for tubing connection to an external brake fluid reservoir.

ORDER CODE	MODEL	PISTON Ø in mm	DESCRIPTION/APPLICATION
0131402	Master brake cylinder	13	Black housing, adjusting screw and damping unit, BMW K 100
0231406	Master brake cylinder	12	Black housing, adjusting screw and damping unit, BMW K 1, K 100, K 1100 up to 12/96
0131411	Master brake cylinder	16	Chrome painted housing, EML, KTM

Technical data: Stroke | 12 mm



100% PRECISELY FITTING

100% FLEXIBLE

100% PERFORMANCE

100% MAGURA-QUALITY

# ACCESSORIES







**Z01 HYDRAULIC ACCESSORIES**

ORDER CODE	MODEL	DESCRIPTION/APPLICATION
<b>CARBON TUBINGS</b>		
0722138 0722137 0722136	Carbon tubing kit Carbon tubing kit Banjo bolt	For HYMEC, length 1,045 mm For HYMEC, length 1,120 mm With bleeding valve M 6x16.5 mm for HYME
<b>STEEL BRAIDED HOSES</b>		
1 0722004 2 0722005 0722015 0722016 0722023 0722057 1 0306956 6 0720505	Steel braided hose Steel braided hose Steel braided hose Steel braided hose Steel braided hose Steel braided hose Steel braided hose Banjo bolt	Length 1,025 mm KTM 4-Stroke Racing, length 975 mm KTM LC8, length 1,140 mm KTM LC4, length 1,025 mm Husaberg, length 1,020 mm KTM 250/380, length 970 mm KTM 2-Stroke 125/200, length 970 mm To fix the clutch tubing with thread M 10x1, inclusive bleeding screw
5 0721786 0721789	Banjo bolt Banjo bolt	For single brake line, without bleeding valve, M 10x1 For two line fittings, M 10x1
<b>PA-TUBINGS</b>		
4 0131890 3 0131893 0131894 0720551 0722679 0431863 7 0720308 8 0720548 0722136 0720581	PA-tubing kit PA-tubing kit PA-tubing kit PA-tubing kit PA-tubing kit PA-tubing Olive/packing unit 10 pcs. Sleeve screw/ packing unit 10 pcs. Banjo bolt Protection tube	Length 1,025 mm With protection tube, length 1,045 mm KTM 65/85 SX, with protection tube, length 910 mm KTM 4-Stroke Racing, length 975 mm For HYMEC, length 1,500 mm, shortable 5 m without accessories To fix the clutch tubing in the sleeve screw 0720548 To connect the clutch tubing and the master cylinder, M 10x1 For HYMEC-versions with PA-tubing For all MAGURA PA-tubing kits
<b>SERVICE-KITS</b>		
9 0722152 10 0721820 10 0721821	Service-Kit HYMEC MAGURA-Blood 100 ml MAGURA-Blood 1 liter	Contains everything you need to refill MAGURA's HYMEC High-quality hydraulic oil based on mineral oil High-quality hydraulic oil based on mineral oil

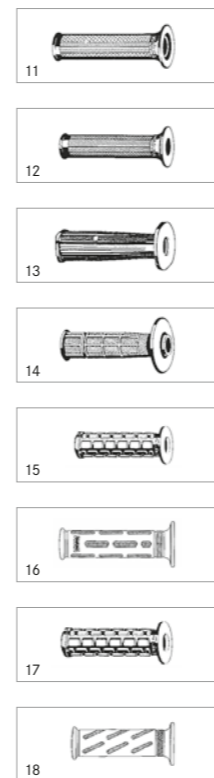
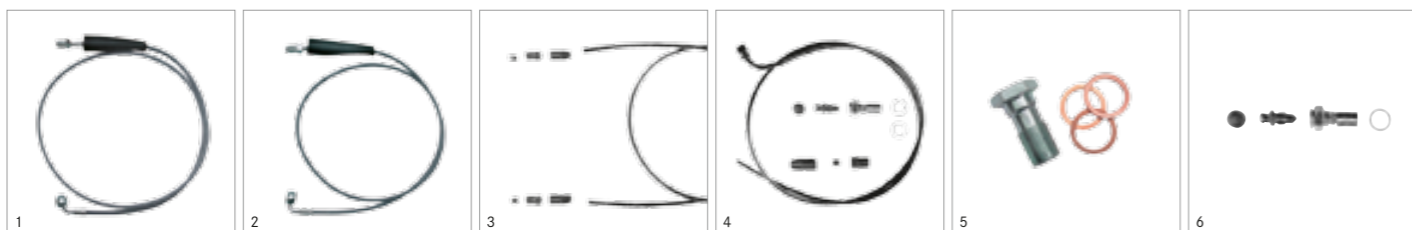

\* sz | rubber black  
szw | rubber black, soft  
ksz | fibre reinforced black  
tsz | thermoplastic elastomer, black

**Z02 GRIPS, PAIRS OF GRIPS**

ORDER CODE	MODEL	DESCRIPTION/APPLICATION	LENGTH in mm
<b>PAIR OF GRIPS</b>			
11 0720850	150 sz*/151 sz* for tube Ø 25/22	BMW/5-models and older	129
12 0720851	125 sz* for tube Ø 25/22	For Oldies and especially for Trial	125
13 0720852	157 sz5* for tube Ø 24/21	BMW-boxer-series, 2-valves/6 up to end of '96, and K-series 2 valves	128
14 0720853	312 szw* for tube Ø 25/22	Special grip for Off-Road	125
15 0720854	250 ksz* for tube Ø 25/22	For mopeds with automatic engines	114
16 0720855	289 tsz* for tube Ø 25/22	Our soft grip for street bikes including BMW C1	126
17 0720856	250 ksz* for tube Ø 25, bead Ø 48	Mopeds with gear grip	116
18 0720920	316 ksz* for tube Ø 25/22	Grip for scooters	116

**Z03 SWITCHES**

ORDER CODE	MODEL	DESCRIPTION/APPLICATION
19 0128496	Switch 558.61	On in paused position, white pusher, micro-switch with spring, for thread 1/4"
20 0128500	Switch 558.12	Off in paused position, black pusher, for thread 1/4", start safety switch for MAGURA-model 163
21 0128510	Switch 558.51	On in paused position, pluggable, blue pusher, for MAGURA-models 116/117, for Suzuki and Simson scooters
22 0128760	Switch housing 582.1	Fits with MAGURA-models 155/15
23 0306891	Clutch switch	BMW models K 1200 RS, R 1200 C, R 1100 S, for MAGURA-model 162
23 0321622	Brake light switch	BMW models K 1, K 1100 R, R 850 R, R 1100 R, for MAGURA-model 288
23 0322971	Brake light switch	BMW models K 1200 RS, R 1200 C, for MAGURA-model 290
24 0306938	Switch 163	For Yamaha XT 660 - HYMEC, cable length 620 mm
25 0550993	Switch 558.34	On in paused position, white pusher, for thread M 8x1
	0723199	Switch 701
26 0420380	Protection cover 558	Hydraulic brake light switch For all switch models 558 small inner-Ø 3.6/ big inner-Ø 10.5
27 0722014	Clutch switch	KTM-models LC 4 from 2003 and LC 8, for thread 1/4", cable length 550 mm
28 0722102	Switch 195	For RADIAL 195 Clutch
28 0722213	Switch 195	For RADIAL 195 Brake, cable length 400 mm
	0723187	Clutch switch
	0723197	Brake light switch
	0723123	Brake light switch

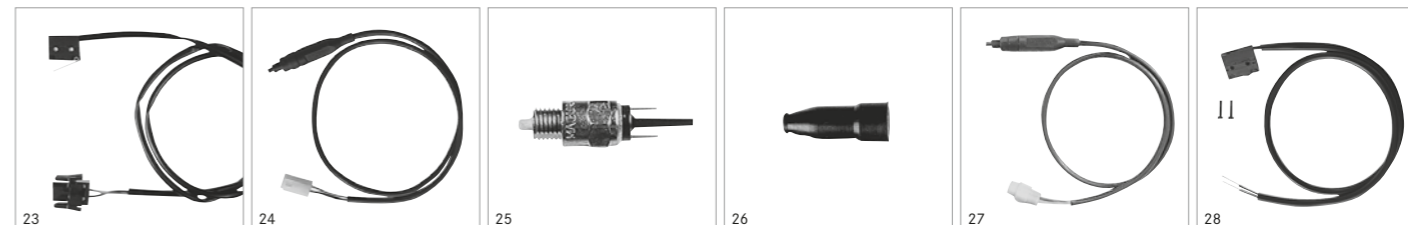
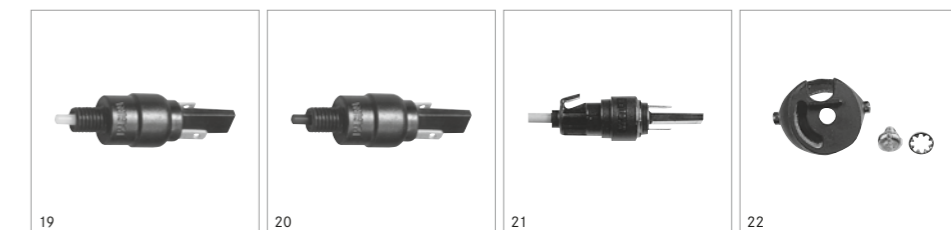



**Z05 SOLDER NIPPLES,  
SOLDER NIPPLE BARRELS**

ORDER CODE	PACKING UNIT	DIMENSIONS in mm		
		Ø width	length	hole
<b>SOLDER NIPPLE BARREL</b>				
0720229	20	8	8	4
0720230	20	8	9	2,6
0720232	20	9/8	15,5	2,5
0720233	20	10/8,3	14,5	2,3
0720234	10	10	11,6	2,3
<b>SOLDER NIPPLE</b>				
0720237	20	6/3,5	13	2,3
0720240	20	6/3,5	8	2,3
0720241	20	6/3,5	8	2,0
0720242	20	6/3,5	8	1,8
0720243	20	3,2	5	1,8
0720246	20	6,5	4	1,8
0720247 B	20	5	3,7	1,5
0720248	20	6	5,5	1,8
0720249	20	5	7,5	1,8
0720250	20	8	9	2,3

**Z05 ADJUSTING SCREWS**

ORDER CODE	PACKING UNIT	DIMENSIONS in mm			
		thread	length	sleeve Ø	cable Ø
<b>GUIDE TUBE</b>					
0720276	10	-	-	6,5	3
<b>UNSLOTTED ADJUSTING SCREW</b>					
0720277	20	M5	27	5	2,5
0720278	20	M6	32	6,8	2,8
0720279	20	M6	41	6,1	2,5
0720280	20	M6	30	6,1	2,5
0720281	20	M6	38	6,5	2,7
0720282	10	M8	36	10,2	4
0720283	10	M8	36	8,2	4
0720284	10	M8	36	7	4
0720286	10	-	31	6,5	3
0720777	10	M10x1	44	11	6,2
<b>SLOTTED ADJUSTING SCREW, WITH KNURLED METAL NUT</b>					
0720288	10	M7	42	6,5	3,5
0720289	10	M7	42	8,2	3,5
0720291	10	M6	32	6,5	2,2
0720292	10	M6	32	6,5	2,2
0720776	10	M10x1	44	11	2,4

**Z05 NIPPLE ASSORTMENT**

ORDER CODE	DESCRIPTION/APPLICATION
0736500	A well sorted selection of 100 various screw nipples, solder nipples and nipple barrels in a very comfortable plastic box. "A need in biker's garage!"

**Z05 SCREW NIPPLES**

ORDER CODE	PACKING UNIT	DIMENSIONS in mm		
		Ø width	length	hole
<b>SCREW NIPPLES</b>				
0720252	20	7	10,5/6,5	2,4
0720253	20	10,6	12,5	2,5
0720254	10	10,8	13	2,8
0720255	20	8	8,5	2,5
0720256	20	7	9	2,5
0720257	20	6	9	2,5
0720258	10	10	18	3
0720260	20	8	15	2,3
0720262	20	5	7,5	2
0720263	20	5,5	10	2
0720264	20	5,5	5,7	1,8

**Z07 DECOMPRESSION LEVERS,  
CHOKE LEVERS...**

ORDER CODE	MODEL	DESCRIPTION/APPLICATION
<b>CONTROL LEVER</b>		
0111370	12	Decompression lever, shank Ø 22 mm with supporting hole Ø 6.7 mm, cable fixing with clamp screw, cable pull 16 mm
0111524	14AL7	Left version, air-lever, black painted, cable fix with nipple, for Ø 22 mm handlebars
0114150	30.1	Stroke 41 mm, single cable, clamp fix, cable fixing with solder nipple
0110100	HA02-right	For round pulley, single cable, thread M6 to screw onto a tube-Ø 22 mm, with solder nipple for cable fixing
0110200	HB02-left	As above, but left version
<b>LEVER</b>		
0114240	37.6	As above, but with an extra disc and spring washer for more power control
0550735	81.13	Stroke 24 mm, right version, for MAGURA-models 114, 115, 224





## GERMANY

## COMPLETE PROGRAMME

**20097 Hamburg**

Joh. J. Matthies GmbH  
Hammerbrookstraße 97  
phone +49 (0)40 237210  
fax +49 (0)40 23721363  
info@matthies.de  
www.matthies.de

**27318 Hoya**

Herrmann Hartje KG  
Deichstraße 120-122  
phone +49 (0)4251 811172  
fax +49 (0)4251 811179  
info@hartje.de  
www.hartje.de

**53117 Bonn**

Fa. Wieres  
Otto-Hahn-Straße 71  
phone +49 (0)228 989970  
fax +49 (0)228 9899720  
vertrieb@wieres.de  
www.wieres.de

**54332 Wasserliesch**

Parts Europe GmbH  
Conrad-Röntgen-Straße 2  
phone +49 (0)6501 96951505  
fax +49 (0)6501 96952650  
info@partseurope.eu  
www.partseurope.eu

**72415 Grosseffingen**

Götz Motorsport  
Neue Gewerbestraße 3  
phone +49 (0)7476 9330  
service@goetz-motorsport.de  
www.goetz-motorsport.de

**80336 München**

Simon Hagl KG  
Schwanthaler Straße 32  
phone +49 (0)89 595009  
fax +49 (0)89 553913  
info@hagl-s.de  
www.hagl-s.de

## OFF-ROAD-PARTS

**36251 Meckbach**

SM-Sport  
Am Wasser 2  
phone +49 (0)6621 72346  
fax +49 (0)6621 73778  
info@sm-sport.de  
www.sm-sport.de

**73084 Salach**

Bader Motorsport  
Schottstraße 13  
phone +49 (0)7162 931544  
fax +49 (0)7162 931545  
jochen.bader.motorsport@t-online.de  
www.jochen-bader-motorsport.de

**83301 Traunreut**

Zupin Motorsport GmbH  
Trostberger Straße 26  
phone +49 (0)8669 8480  
fax +49 (0)8669 848590  
info@zupin.de  
www.zupin.de

## MOFA-/MOKICK-PARTS

**33649 Bielefeld**

Steinkrüger & Becker  
Erpestraße 57  
phone +49 (0)521 947180  
fax +49 (0)521 947184024568

**97526 Schweinfurt-Sennfeld**

E. Wiener Bike Parts GmbH  
Max-Planck-Straße 8  
phone +49 (0)9721 65010  
fax +49 (0)9721 650173  
info@bike-parts.de  
www.bike-parts.de

## CLASSIC-BIKE-PARTS

**24568 Kaltenkirchen**

Ernst Weisswange  
Hamburger Straße 73  
**Military motorcycles**  
phone +49 (0)4191 3326  
fax +49 (0)4191 88091  
ernst@weisswange-motorradteile.de  
www.weisswange-motorradteile.de

**33649 Bielefeld**

Steinkrüger & Becker  
Erpestraße 57

**Puch**

phone +49 (0)521 947180  
fax +49 (0)521 947184042899

**42899 Remscheid**

(Lüttringhausen)  
Motorrad-Stemler GmbH  
Garschager Heide 29  
**Adler, AWO, BMW, DKW, EMW, Horex, IFA, NSU, Triumph, Victoria, Zündapp, Steib**  
phone +49 (0)2191 53067  
fax +49 (0)2191 590349  
info@motorrad-stemler.de  
www.motorrad-stemler.de

**60327 Frankfurt**

Uli's Motorradladen GmbH  
U. Seiwert  
Gutleutstraße 144  
**BMW**  
phone +49 (0)69 239319  
fax +49 (0)69 233840  
info@ulismotorradladen.de  
www.ulismotorradladen.de

**64750 Lützelbach**

Kurt Heumann  
Hardtstraße 6  
**All classic bikes, as in A like Adler to Z as in Zündapp**  
phone +49 (0)6165 912053  
fax +49 (0)6165 912054  
heumannzweirad@t-online.de  
www.heumannzweirad.de

**70806 Kornwestheim**

Kreidler Dienst  
Kurt Hellmuth  
Aldinger Straße 2  
**Kreidler**  
phone +49 (0)7154 4686  
fax +49 (0)7154 4657  
info@kreidlerdienst.de  
www.kreidlerdienst.de

**72336 Balingen**

Bernhard Greiner  
Am Bangraben 16  
**Motorcycles of the 50's**  
phone +49 (0)7433 15188  
fax +49 (0)7433 6245  
info@greiner-oldtimerteile.de  
www.greiner-oldtimerteile.de

**80336 München**

Simon Hagl KG  
Schwanthaler Straße 32  
**Zündapp**  
phone +49 (0)89 595009  
fax +49 (0)89 553913  
www.hagl-s.de  
info@hagl-s.de

**96120 Bischberg**

Hilmar Gebhardt  
Hauptstraße 43  
**Hercules**  
phone +49 (0)951 3029519  
fax +49 (0)951 3029520  
zweirad-gebhardt@t-online.de

## WORLDWIDE

International representatives and distributors

## Asia

MAGURA Asia Limited Co.  
No. 9, Industrial Park 10th Road  
Shi-Tun District  
Taichung City, 40755, Taiwan  
phone +886 4 23163388  
fax +886 4 23599910  
info@magura.com.tw

## Australia

Distributor  
100% MX  
Ferntree Gully  
AUS-3156 Victoria  
phone +61 3 97536955  
fax +61 3 97536966  
info@100mx.com  
www.shop100mx.com

## Austria

Distributor  
Ing. Hubert Knittel  
Lastbergstrasse 41  
A-3031 Pressbaum  
phone +43 2233 4368314  
h.knittel@josefzimmer.at

## Belgium

Distributor  
Rino Trading Company N.V.  
Industriepark 29  
B-2235 Hulshout  
phone +32 15 228433  
fax +32 15 230628  
info@rinotrading.be  
www.rinotrading.be

## Czech Republic

Distributor  
Motozloch  
Pisecká 1334  
CZ-38601 Strakonice  
phone +42 774455440  
info@motozloch.cz  
www.motozloch.cz

## Finland

Distributor  
Uimonen Trading OY  
Kaskimäenkatu 7  
SF-00021 Laskutus  
phone +358 3 3565400  
fax +358 3 2656700  
info@tpuimonen.fi  
www.tpuimonen.fi

## Distributor

Tokimoto OY  
Piispankyläntie 10  
SF-01730 Vantaa  
phone +358 400236713  
fax +358 8546430  
myynti@tokimoto.fi  
www.tokimoto.fi

## France

Representative  
Jean-Michel Pfrimmer  
2, Rue des Vergers  
F-67450 Lampertheim  
phone +33 3 88200864  
j.michel.pfrimmer@orange.fr

## Distributor

Seurat Puissance 3  
Z.I.-21 Rue Jacques Germain  
F-21420 Savigny lès Beaune  
phone +33 3 80229668  
fax +33 3 80223479  
info@seurat3.fr  
www.seurat3.fr

## Distributor

Bihr S.A.S.  
Z.I. Parc 3, 7 Rue Robert Schumann  
F-68870 Bartenheim  
phone +33 3 89703030  
fax +33 3 89703099  
info@bihr.eu  
www.bihr.eu

## Greece

Distributor  
Kafounis Motorsport  
Achilleos 42-44-46  
GR-10436 Athens  
phone +30 210 5232605  
fax +30 210 5226607  
info@kafounis.gr  
www.kafounis.com

## Hungary

Distributor  
X-Bike Borsay KFT  
Csömöri út 157  
H-1161 Budapest  
phone +36 1 4056653  
fax +36 1 4051378  
info@x-bike.hu  
www.x-bike.hu

## Indonesia

Tiara Sutan Motorsport  
Puri Media Kempangan A11/48  
Jakarta Barat  
phone +62 21 58350059  
fax +62 21 58350159  
sales1@tiarasutan.com  
www.tiarasutan.com

## Italy

Distributor  
Motocross Marketing S.R.L.  
Via G. Verdi, 26/A  
I-21040 Carnago (VA)  
phone +39 03 31991077  
fax +39 03 31995583  
info@motocrossmarketing.com  
www.motocrossmarketing.com

## Japan

Distributor  
MC International Inc.  
Tadao Kiji  
24-3, Enokicho, Suitashi  
Nishi-ku  
J-564-0053 Osaka  
phone +81 663185000  
fax +81 665360907  
t.kiji@nifty.com

## Netherland

Distributor  
Ariete Holland  
Hersel 5  
NL-5715 PL Lierop  
phone +31 492 332099  
info@ariete.nl  
www.ariete.nl

## Norway

Distributor  
Kjell Berg A/S  
Strandgaten 6  
N-3960 Stathelle  
phone +47 35 962111  
post@kjell-berg.no  
www.kjell-berg.no

## Poland

Distributor  
JG Sport  
Ul. Wloclawska 252 C  
PL-87-100 Torun  
phone +48 56 6543832  
fax +48 56 6543832  
jgsport@jgsport.com.pl  
www.jgsport.com.pl

## Portugal

Distributor  
Bicimotor, LDA  
Rua Visconde das Devesas, 128/132  
P-4400-336 Vila Nova de Gaia  
phone +351 222084124  
fax +351 222008785  
pleite@bicimotor.pt  
www.bicimotor.pt

## South Africa

Distributor  
Bike Product Services  
Unit 7 South, Anvil Park 133,  
Craig Road  
Anderbolt, Boksburg  
ZA-1459 Gauteng  
phone +27 11 91849111046  
fax +27 11 9184913  
bikeproducts@mweb.co.za  
www.bikeproducts.co.za

## Spain

Representative  
Carlos Pérez Tolsa  
Valencia, 587 5°1a  
E-08026 Barcelona  
phone +34 619702946  
fax +34 932317731  
c.perez@spinolaperez.com  
www.spinolaperez.com

## Distributor

Diametral  
Carrer Martorelles N.16  
E-08170 Montornès del Vallès  
(Barcelona)  
phone +34 93 5723516  
fax +34 93 5683628  
diametral@diametral.es  
www.diametral.es

## Sweden

Distributor  
Cross Center International AB  
Box 11  
S-56621 Habo  
phone +46 36 46664  
fax +46 36 41656  
tobbe@cross-center.com  
www.cross-center.com

## Distributor

Duells  
Box 6093  
S-40060 Göteborg  
phone +46 31 7276300  
fax +46 31 582234  
info@duells.se  
www.duells.se

## Distributor

Nord Delar AB  
Kämpevägen 26  
S-55302 Jönköping  
phone +46 36 390995  
fax +46 36 393895  
sales@norddelar.se  
www.norddelar.se

## Switzerland

Distributor  
AZE Handels- u. Vertriebs AG  
Sihlquai 278  
CH-8031 Zürich  
phone +41 44 2727611  
fax +41 44 2711088  
info@aze.ch  
www.aze.ch

## United Kingdom

Distributor  
Venhill Engineering Ltd F  
21 Ranmore Road  
UK-Dorking, Surrey RH4 1HE  
phone +44 1306 885111  
fax +44 1306 740535  
info@venhill.co.uk  
www.venhill.co.uk

## USA &amp; Canada

Representative/Distributor  
MAGURA USA Corp.  
724 West Clem  
Olney, IL 62450, USA  
phone +1 618 395 2200  
fax +1 618 395 4711  
moto@magurusa.com  
www.magura.com

## Primary Distributors

MAGURA products are distributed through several smaller wholesalers, please ask MAGURA USA to find out if your favorite distributor handles MAGURA motorcycle products.

## Primary Distributors

Tucker Rocky Distributing  
4900 Alliance Gateway Freeway  
Fort Worth, TX 76177, USA  
tuckerrocky@tuckerrocky.com  
www.tuckerrocky.com

## Primary Distributors

Parts Unlimited/Le Mans  
PO BOX 5222  
Janesville, WI 53547, USA  
phone +1 608 7581111  
fax +1 608 7581634  
www.parts-unlimited.com  
www.partseurope.eu

## Primary Distributors

Western Power Sports, Inc.  
601 East Gowen Road  
Boise, ID 83716, USA  
phone +1 800 9993388  
fax +1 208 3758901