

INSTALLATION

INSTRUCTIONS-A

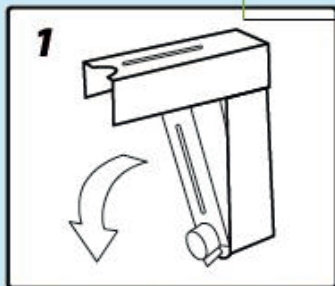

1 Open the back of the unit. Press on the button and pull on the front panel. Remove the refill container.

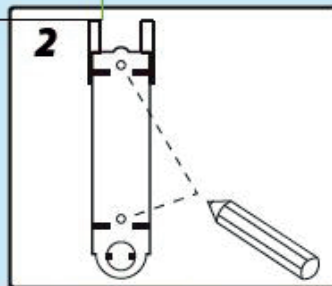

2 Put the unit in place. Hold the back plate against the wall and mark the location of the screw holes.

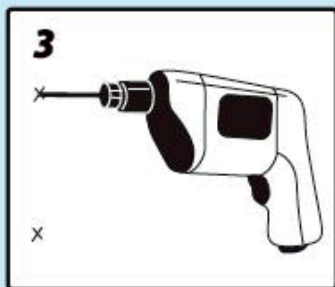

3 Drill the holes.

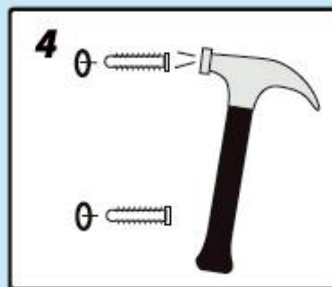

4 Use a hammer to help put in the wall plugs.

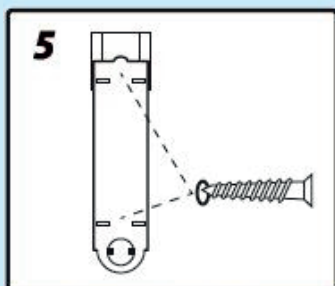

5 Place the unit against the wall. Screw into position.

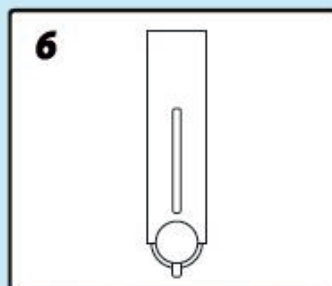

6 Reinsert refill container and close.

INSTRUCTIONS-B

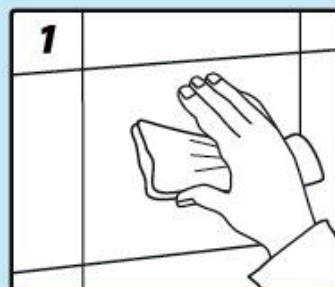

1 Clean the wall carefully (preferably with rubbing alcohol) and dry well.

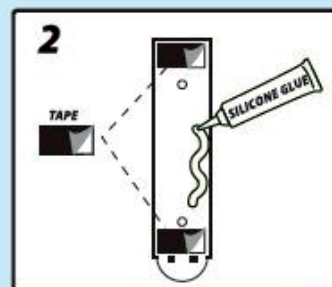

2 Apply double-sided tape to the back of the unit. Remove protective covering on tape.

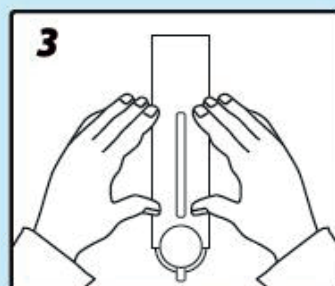

3 Make wavy lines of silicone on back of the dispenser where it will touch the wall. Please use all of the tube for maximum bond. Press firmly onto wall.

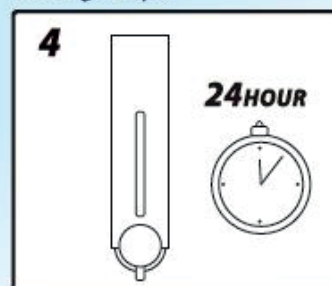

4 Hold in place for one minute. Do not fill container for 24 hours to allow the silicone time to fully dry.